

EPIC® CONNECTORS

HBE Series

The HBE series inserts are suitable for applications with high voltages and current. The inserts can be terminated in a variety of ways: screw, crimp, or “spring” cage clamp.

These inserts fit into the HBE Series housings which are standard with fixed levers.

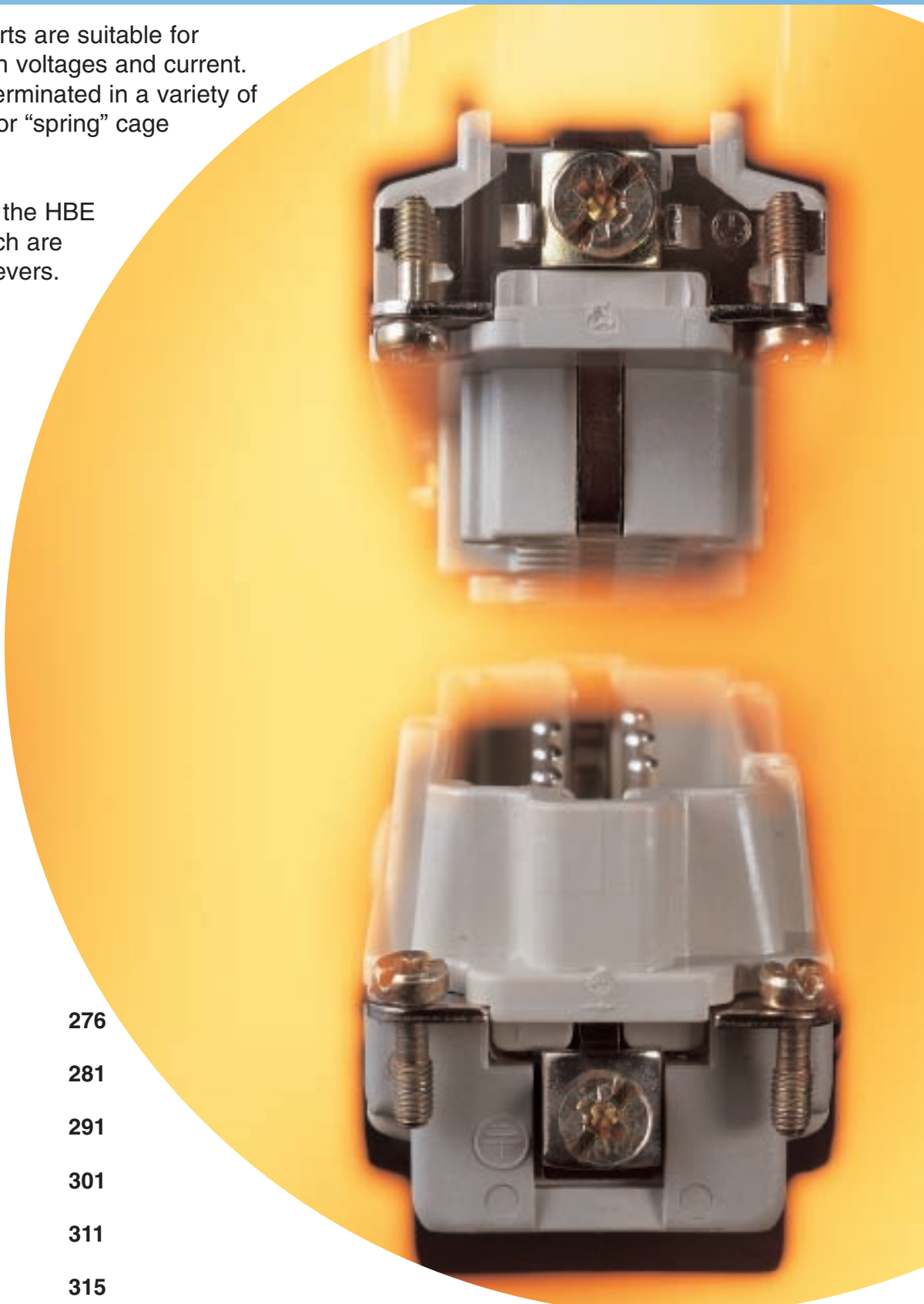

HBE 6 Series	276
HBE 10 Series	281
HBE 16 Series	291
HBE 24 Series	301
HBE 32 Series	311
HBE 48 Series	315

TECHNICAL DATA

Number of Contacts:	6, 10, 16, 24, 32, 48 (+PE)	
Screw Termination & Crimp Termination:		
Rated Voltage:	VDE: 500V EPIC® HBE 6 - 48 CSA: 600V EPIC® HBE 6 - 48	UL: 600V EPIC® HBE 6 - 48
Rated Current:	VDE: 16A EPIC® HBE 6 - 48 CSA: 16A EPIC® HBE 6 - 48	UL: 16A EPIC® HBE 6 - 48
Temperature Range:	-40°C to 125°C	
Cage Clamp:		
Rated Voltage:	VDE: 500V EPIC® HBE 6 - 48 CSA: 600V EPIC® HBE 6 - 48	UL: 600V EPIC® HBE 6 - 48
Rated Current:	VDE: 16A EPIC® HBE 6 - 48 CSA: 16A EPIC® HBE 6 - 48	UL: 16A EPIC® HBE 6 - 48
Pollution Level:	3	
Dimensioning Transient:	6 kV	
Termination Type:		
	<u>mm²</u>	<u>AWG</u>
Screw Termination:	0.5 - 2.5 mm ²	20 - 14
Crimp Termination:	0.5 - 4.0 mm ²	20 - 12
Cage Clamp Termination:	0.5 - 2.5 mm ²	20 - 14
Contacts:		
Screw Termination:	Copper alloy, silver plated	
Crimp Termination:	Copper alloy, silver plated/ gold plated	
Cage Clamp Termination:	Copper alloy, silver plated	
Mating Cycles:	100 (higher mating cycles depending on the application)	
Contact Resistance:		
Screw Termination:	<2 mOhm	
Crimp Termination:	<2 mOhm	
Cage Clamp termination:	1.5 - 4 mOhm	

Please note that terminal block inserts are available. Please see website.

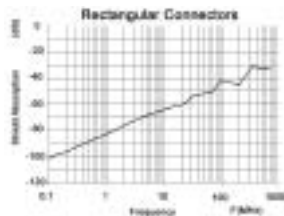

For Panel Mount Base



For Surface Mount Base & Cable Coupler Hood

EMC PROTECTION

	PG/NPT	Metric
HBE 6 Panel Mount Base	70.3500	79.3500
HBE 6 Surface Mount & Cable Coupler Hood	70.3520	79.3520
HBE 10 Panel Mount Base	70.3501	79.3501
HBE 10 Surface Mount & Cable Coupler Hood	70.3521	79.3521
HBE 16 Panel Mount Base	70.3502	79.3502
HBE 16 Surface Mount & Cable Coupler Hood	70.3522	79.3522
HBE 24 Panel Mount Base	70.3503	79.3503
HBE 24 Surface Mount & Cable Coupler Hood	70.3523	79.3523

HBE INSERTS: DERATING CURVES

**HBE SCREW TERMINATED:
1.5 mm² (16 AWG)**

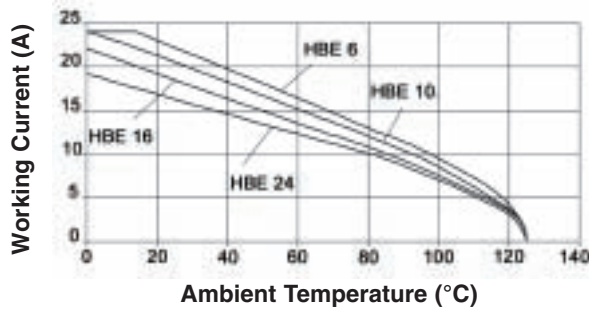

**HBE SCREW TERMINATED:
2.5 mm² (14 AWG)**

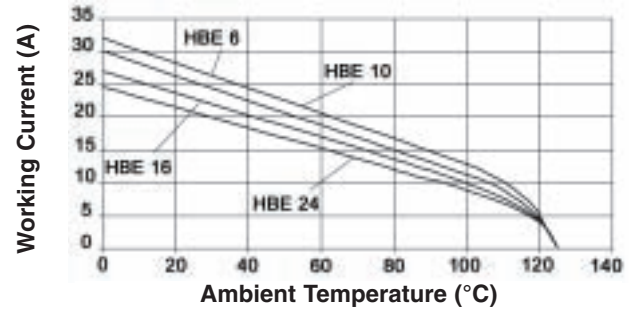

**HBE CRIMP TERMINATED:
1.5 mm² (16 AWG)**

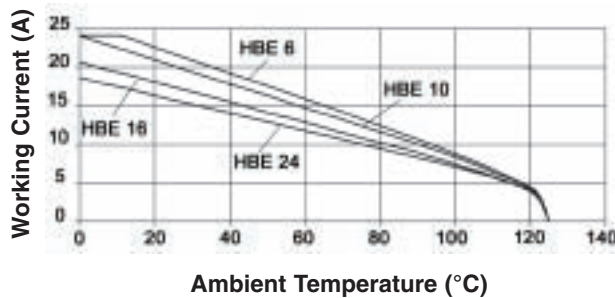

**HBE CRIMP TERMINATED:
2.5 mm² (14 AWG)**

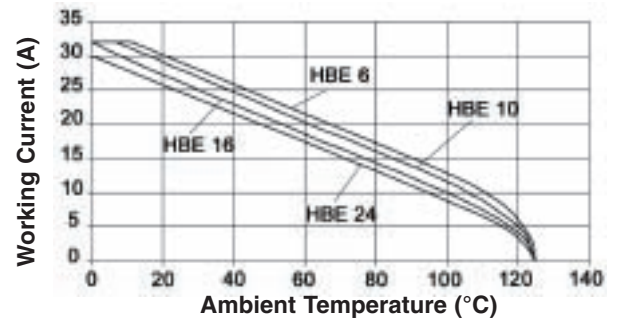

**HBE CAGE CLAMP:
1.5 mm² (16 AWG)**

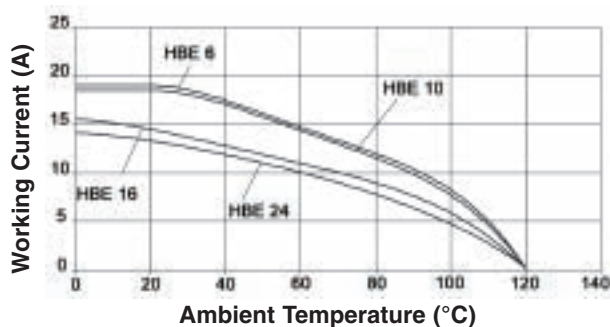

**HBE CAGE CLAMP:
2.5 mm² (14 AWG)**

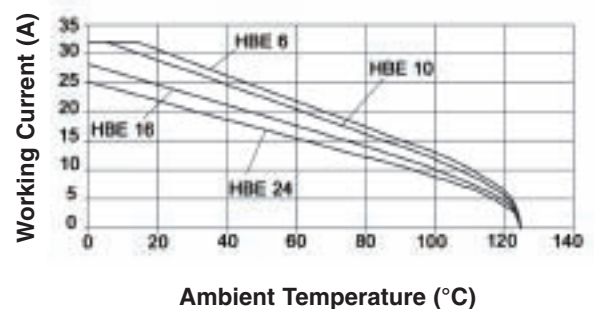

EPIC® CONNECTORS

HBE Housings: Technical Data



Specifications:	DIN 43652
Temperature Range:	-40°C to +125°C
Protection class:	NEMA 4, IP65
Material:	HBE 6 - 48: aluminum alloy, powder coated

STANDARD GREY COATING (NEMA 4)

PG



NPT

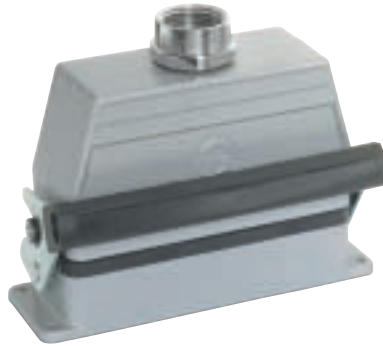

METRIC



HBE 6- 48: aluminum alloy, powder coated (grey), locking levers and bolts made of zinc plated steel.

For industrial applications in demanding environments.

EP BLACK COATING (NEMA 4X)

PG



NPT



METRIC



HBE 6 - 48 EP: Environmentally Protected: aluminum alloy, powder coated (black), locking levers and bolts made of stainless steel.

For industrial applications in extremely demanding environments with aggressive atmospheres.

EPIC[®] CONNECTORS

HBE Panel Cut-Outs for Panel Mount Bases

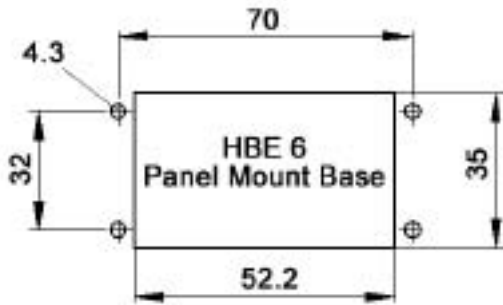

Fits the following plugs & receptacles:
HBE 6, HDD 24, HEE 10, and 2 Module Frames.

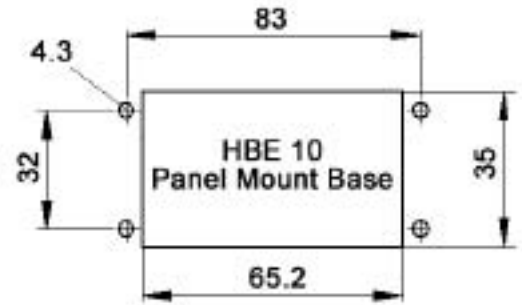

Fits the following plugs & receptacles: HBE 10,
HBVE 3, HDD 42, HEE 18 and 3 Module Frames.

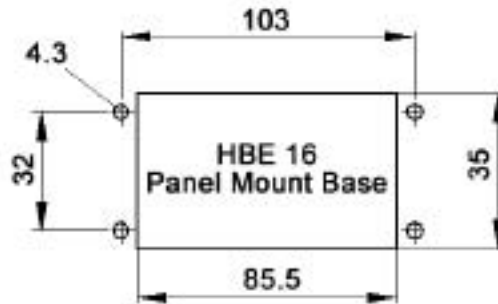

Fits the following plugs & receptacles: HBE 16, HBS 6, HBVE 6, HD 40,
HDD 72, HEE 32, 5 Module Frames, 4 Pwr/0 Sgl, and 4 Pwr/2 Sgl.

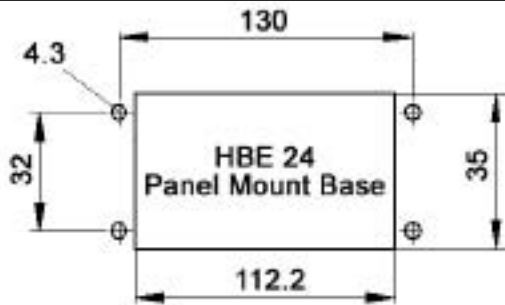

Fits the following plugs & receptacles: HBE 24, HBVE 10,
HD 64, HDD 108, HEE 46, 7 Module Frame, and 4 Pwr/8 Sgl.

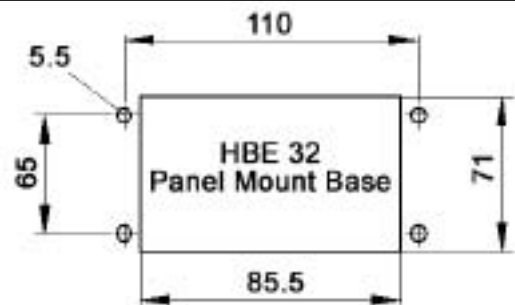

Fits the following plugs & receptacles: HBE 32, HBS
12, HD 80, HDD 144, HEE 64, and 10 Module Frames.

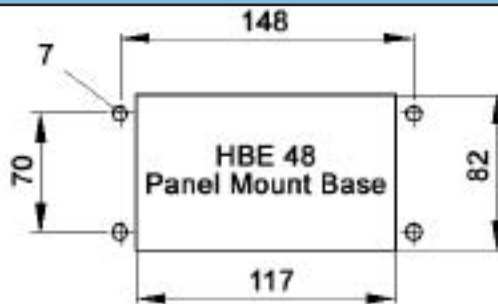

Fits the following plugs & receptacles: HBE 48, HD
128, HDD 216, HEE 92, and 14 Module Frames.
All dimensions are in mm.

EPIC® CONNECTORS

HBE 6 Plugs & Receptacles



SCREW & CRIMP TERMINATED INSERTS

SCREW TERMINATED

View from Cable Side

CRIMP TERMINATED

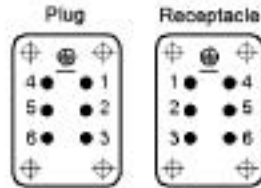

Panel Cut-Out
(Insert Only)

Contacts Sold Separately

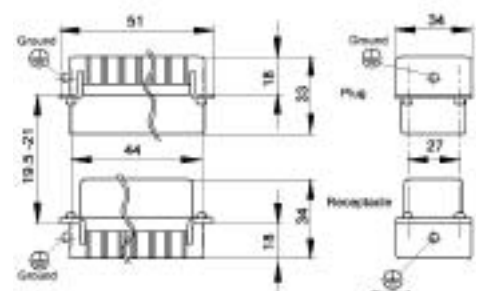
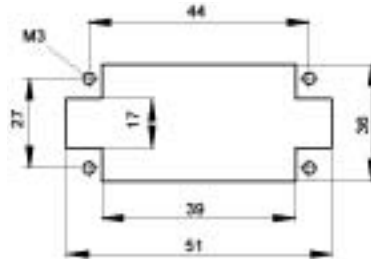
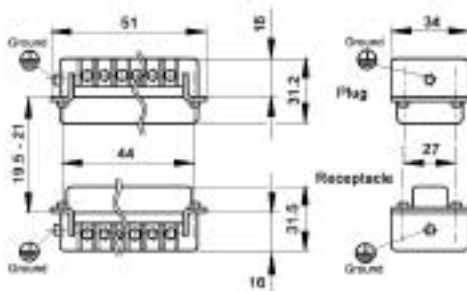

All dimensions are in mm.

These inserts fit in the HBE 6 Series Housings.

	Plug	Receptacle
Screw Terminated with wire protection	10.1900	10.1910
Screw Terminated without wire protection	10.1901	10.1911
Crimp Terminated: Machine	10.1800	10.1810

Crimp Contacts are on the next page.

SCREWLESS SPRING CAGE CLAMP INSERTS



Panel Cut-Out
(Insert Only)

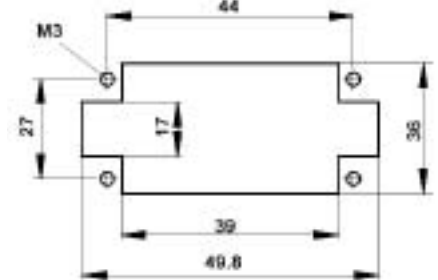
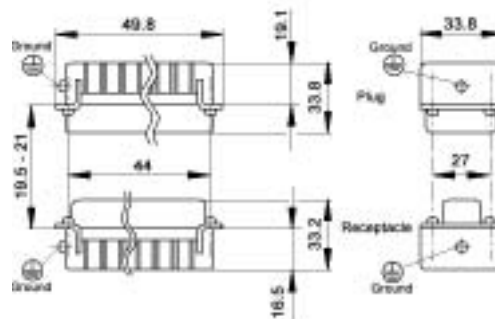

Same View from Cable Side as Screw & Crimp Termination

These inserts fit in the HBE 6 Series Housings.

	Plug	Receptacle
Screwless Cage Clamp	10.4000	10.4010

All dimensions are in mm.

EPIC® CONNECTORS

Accessories for Crimp Terminated Inserts



SCREW TERMINATED TERMINAL BLOCK INSERTS

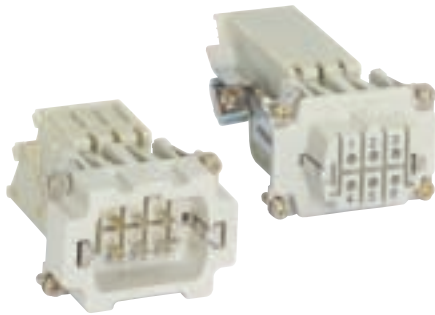

These terminal block inserts only fit in HBE 6 panel mount bases

View from Cable Side

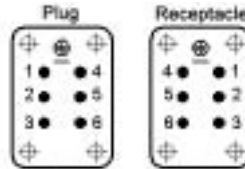

All dimensions are in mm.

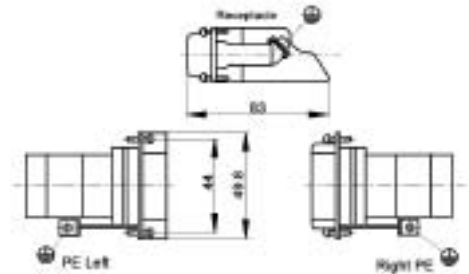

One terminal block insert mates with one screw terminated insert.

	Receptacle
Terminal Block: Right Ground	70.3111
Terminal Block: Left Ground	70.3101

MACHINED CONTACTS: DIAMETER 2.5 MM²

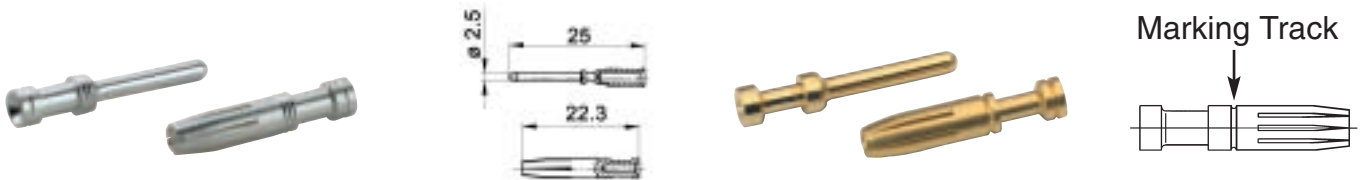

Bags of 100

mm ²	AWG	Silver		Gold		Stripping Length (mm)	# of Marking Tracks
		Pin	Socket	Pin	Socket		
0.5	20	11.1900	11.1950	11.1920	11.1970	Pin=7.4, Socket =7.3	-
.75 - 1.0	18	11.1901	11.1951	11.1921	11.1971	Pin=7.4, Socket =7.3	1
1.5	16	11.1902	11.1952	11.1922	11.1972	Pin=7.4, Socket =7.3	2
2.5	14	11.1903	11.1953	-	-	Pin=7.4, Socket =7.3	3
4.0	12	11.1904	11.1954	-	-	Pin=7.4, Socket =7.3	-

Part number= 1 contact

CRIMP TOOLS

Wire Gauge: 0.5 - 4.0 mm² for the HBE Crimp Inserts



Locator
11.1472



Crimp Tool
11.1470



Crimp Dies
11.1471

For removal of contacts use a slotted screwdriver. No special tool is necessary.

Please note that the crimp range for this tool is 0.14 to 2.5 mm² (AWG 26 - 14) with the appropriate crimp dies.

EPIC® CONNECTORS

HBE 6 Housings: Single Lever on Base



HOODS

TOP ENTRY

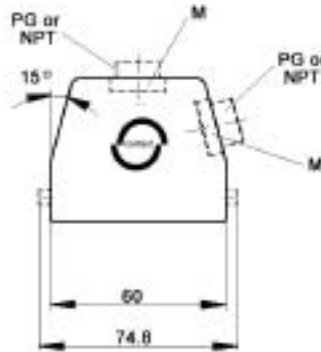
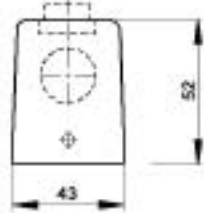

SIDE ENTRY



All dimensions are in mm.

Position of Cable Entry	Size of Entry			Standard Grey Coating			Black Coating (EP)		
	PG	NPT	Metric	PG Part #	NPT Part #	Metric Part #	PG Part #	NPT Part #	Metric Part #
Top Entry	13.5	1/2"	20	10.0110	10.0110 NP	19.0110	70.0216	70.0216 NP	79.0216
	16	1/2"	25	10.0210	10.0210 NP	19.0210	70.0210	70.0210 NP	79.0210
Side Entry	13.5	1/2"	20	10.0120	10.0120 NP	19.0120	70.0236	70.0236 NP	79.0236
	16	1/2"	25	10.0220	10.0220 NP	19.0220	70.0230	70.0230 NP	79.0230

Top Entry metric hoods do not come with a neck.

HIGH PROFILE HOODS

TOP ENTRY

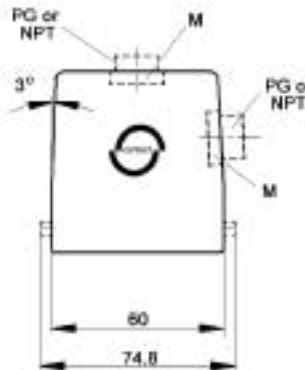

SIDE ENTRY



All dimensions are in mm.

Position of Cable Entry	Size of Entry			Standard Grey Coating			Black Coating (EP)		
	PG	NPT	Metric	PG Part #	NPT Part #	Metric Part #	PG Part #	NPT Part #	Metric Part #
Top Entry	21	3/4"	25	70.0202	70.0202 NP	79.0202	70.0212	70.0212 NP	79.0212
	29	1"	32	70.0204	70.0204 NP	79.0204	70.0214	70.0214 NP	79.0214
Side Entry	21	3/4"	25	70.0222	70.0222 NP	79.0222	70.0232	70.0232 NP	79.0232
	29	1"	32	70.0224	70.0224 NP	79.0224	70.0234	70.0234 NP	79.0234

Top Entry metric hoods do not come with a neck.

EPIC® CONNECTORS

HBE 6 Housings: Single Lever on Base



PANEL MOUNT BASES

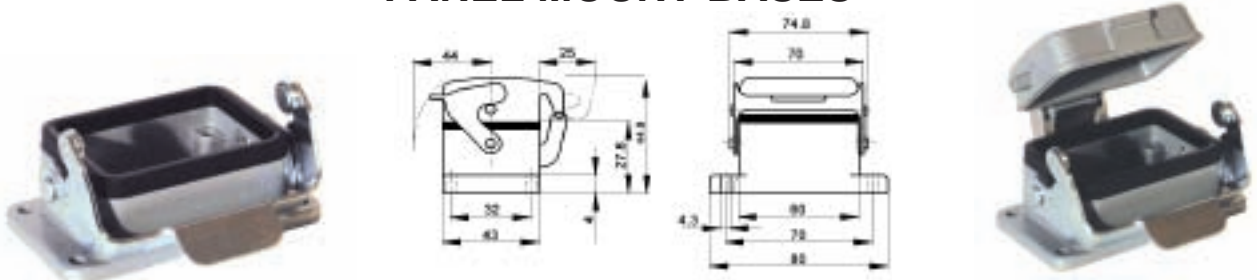

All dimensions are in mm.

Description	Standard Grey Coating	Black Coating (EP)
Panel Mount without Dust Cover	10.0030	70.0025
Panel Mount with Dust Cover	10.0040	70.0045

SURFACE MOUNT BASES

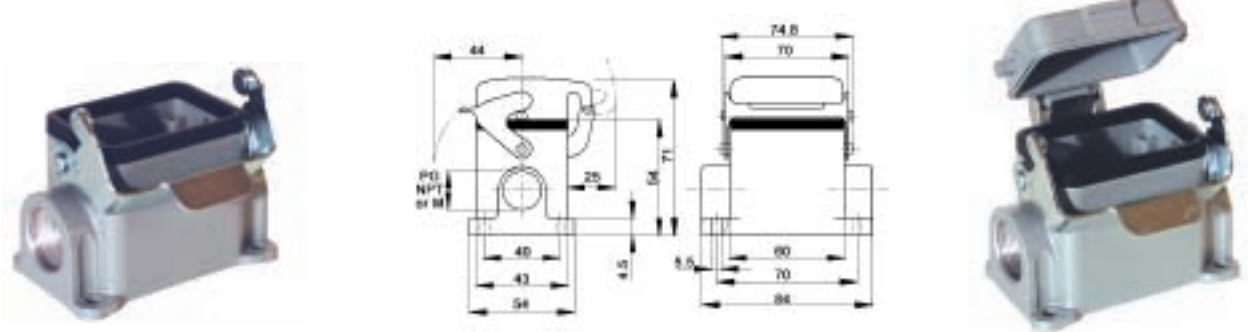

All dimensions are in mm.

# of Entries	Size of Entry			Standard Grey Coating			Black Coating (EP)		
	PG	NPT	Metric	PG Part #	NPT Part #	Metric Part #	PG Part #	NPT Part #	Metric Part #
2 Entries	16	1/2"	20	10.0060	10.0060 NP	19.0060	70.0080	70.0080 NP	79.0080
	-	-	25	-	-	79.0066	-	-	79.0086
1 Entry	16	1/2"	20	10.0050	10.0050 NP	19.0050	70.0070	70.0070 NP	79.0070
	-	-	25	-	-	79.0056	-	-	79.0076
2 Entries with dust cover	16	1/2"	20	10.0090	10.0090 NP	19.0090	70.0180	70.0180 NP	79.0180
	-	-	25	-	-	79.0166	-	-	79.0186
1 Entry with dust cover	16	1/2"	20	10.0070	10.0070 NP	19.0070	70.0170	70.0170 NP	79.0170
	-	-	25	-	-	79.0156	-	-	79.0176

DUST COVERS WITH ATTACHMENT STRING



Material:

Thermoplastic Resin

Temperature:

-40°C to 125°C

	Part #
Dust cover with single lever and gasket for HBE 6 Hoods	10.0165
Dust cover with single lever bolts for HBE 6 Panel Mount or Surface Mount Base/ Cable Coupler Hood	10.0150

EPIC® CONNECTORS

HBE 6 Housings: Single Lever on Base



HIGH PROFILE SURFACE MOUNT BASES

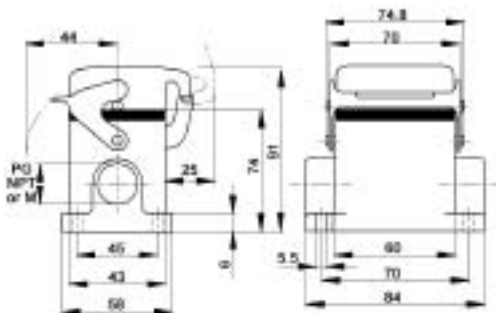

All dimensions are in mm.

# of Entries	Size of Entry			Standard Grey Coating			Black Coating (EP)		
	PG	NPT	Metric	PG Part #	NPT Part #	Metric Part #	PG Part #	NPT Part #	Metric Part #
2 Entries	21	3/4"	25	70.0062	70.0062 NP	79.0062	70.0082	70.0082 NP	79.0082
	29	1"	32	70.0064	70.0064 NP	79.0064	70.0084	70.0084 NP	79.0084
1 Entry	21	3/4"	25	70.0052	70.0052 NP	79.0052	70.0072	70.0072 NP	79.0072
	29	1"	32	70.0054	70.0054 NP	79.0054	70.0074	70.0074 NP	79.0074
2 Entries with dust cover	21	3/4"	25	70.0162	70.0162 NP	79.0162	70.0182	70.0182 NP	79.0182
	29	1"	32	70.0164	70.0164 NP	79.0164	70.0184	70.0184 NP	79.0184
1 Entry with dust cover	21	3/4"	25	70.0152	70.0152 NP	79.0152	70.0172	70.0172 NP	79.0172
	29	1"	32	70.0154	70.0154 NP	79.0154	70.0174	70.0174 NP	79.0174

CABLE COUPLER HOODS

STANDARD PROFILE

HIGH PROFILE

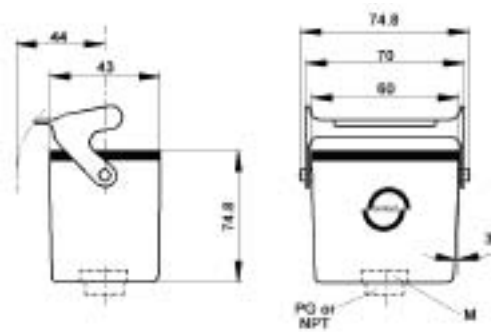
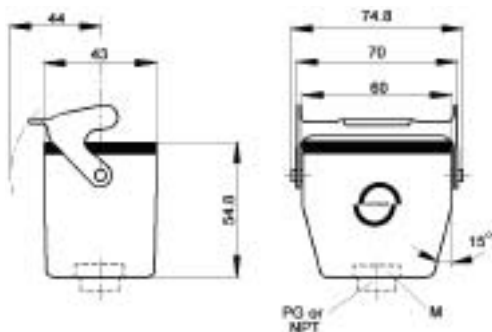

Profile	Size of Entry			Standard Grey Coating			Black Coating (EP)		
	PG	NPT	Metric	PG Part #	NPT Part #	Metric Part #	PG Part #	NPT Part #	Metric Part #
Standard Profile	13.5	1/2"	20	10.0140	10.0140 NP	19.0140	-	-	79.0110
	16	1/2"	25	10.0240	10.0240 NP	19.0240	70.0110	70.0110 NP	79.0116
High Profile	21	3/4"	25	70.0102	70.0102 NP	79.0102	70.0112	70.0112 NP	79.0112
	29	1"	32	70.0104	70.0104 NP	79.0104	70.0114	70.0114 NP	79.0114

Cable coupler metric hoods do not come with a neck.

EPIC® CONNECTORS

HBE 10 Plugs & Receptacles



SCREW & CRIMP TERMINATED INSERTS

SCREW TERMINATED



View from Cable Side

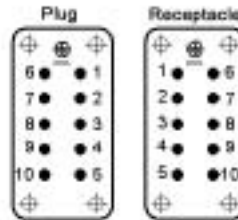

CRIMP TERMINATED

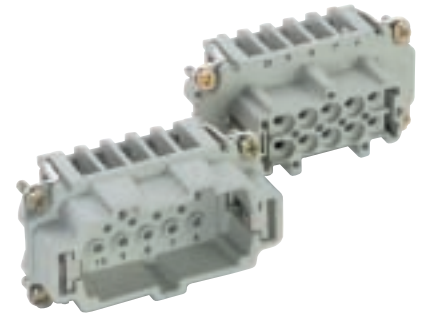

Contacts Sold Separately

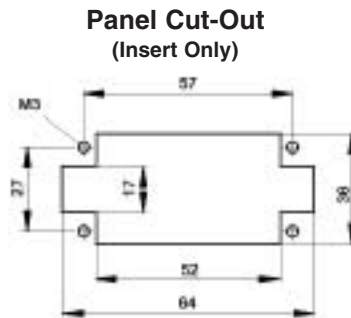
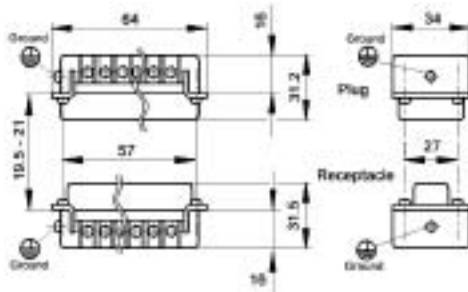

All dimensions are in mm.

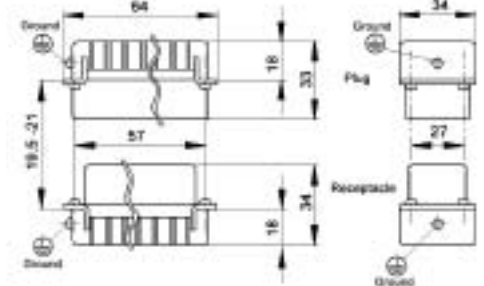

These inserts fit in the HBE 10 Series Housings.

	Plug	Receptacle
Screw Terminated: with wire protection	10.1920	10.1930
Screw Terminated: without wire protection	10.1921	10.1931
Crimp Terminated: Machine	10.1820	10.1830

Crimp Contacts are on the next page.

SCREWLESS SPRING CAGE CLAMP INSERTS



Same View from Cable Side as Screw & Crimp Termination

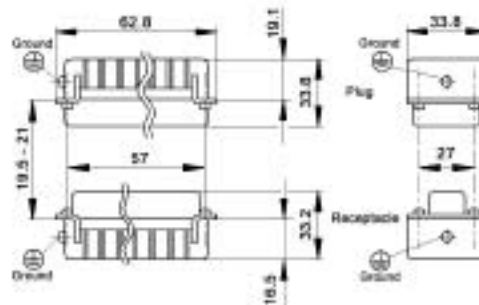

All dimensions are in mm.

Panel Cut-Out

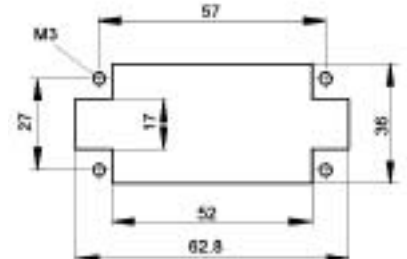

	Plug	Receptacle
Screwless Cage Clamp	10.4001	10.4011

These inserts fit in the HBE 10 Series Housings.

EPIC® CONNECTORS

Accessories for Crimp Terminated Inserts



SCREW TERMINATED TERMINAL BLOCK INSERTS

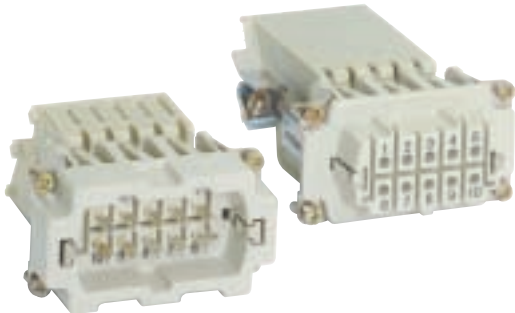

View from Cable Side

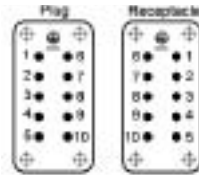

All dimensions are in mm.

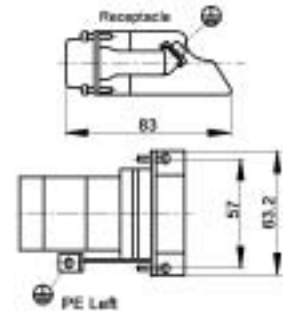

These terminal block inserts only fit in HBE 10 panel mount bases

	Receptacle
Terminal Block: Left Ground	70.3121

One terminal block insert mates with one screw terminated insert.

MACHINED CONTACTS: DIAMETER 2.5 MM²

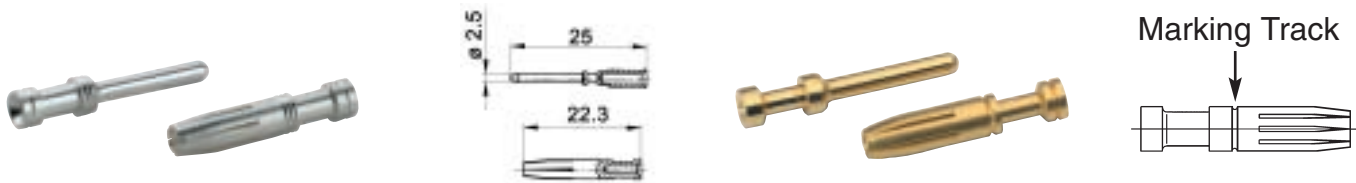

Bags of 100

mm ²	AWG	Silver		Gold		Stripping Length (mm)	# of Marking Tracks
		Pin	Socket	Pin	Socket		
0.5	20	11.1900	11.1950	11.1920	11.1970	Pin=7.4, Socket =7.3	-
.75 - 1.0	18	11.1901	11.1951	11.1921	11.1971	Pin=7.4, Socket =7.3	1
1.5	16	11.1902	11.1952	11.1922	11.1972	Pin=7.4, Socket =7.3	2
2.5	14	11.1903	11.1953	-	-	Pin=7.4, Socket =7.3	3
4.0	12	11.1904	11.1954	-	-	Pin=7.4, Socket =7.3	-

Part number= 1 contact

CRIMP TOOLS

Wire Gauge: 0.5 - 4.0 mm² for the HBE Crimp Inserts



Locator
11.1472



Crimp Tool
11.1470



Crimp Dies
11.1471

For removal of contacts use a slotted screwdriver. No special tool is necessary.

Please note that the crimp range for this tool is 0.14 to 2.5 mm² (AWG 26 - 14) with the appropriate crimp dies.

EPIC® CONNECTORS

HBE 10 Housings: Single Lever on Base



HOODS

TOP ENTRY

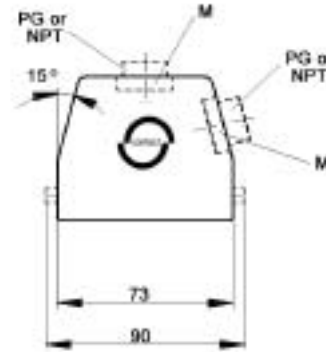

SIDE ENTRY



All dimensions are in mm.

Position of Cable Entry	Size of Entry			Standard Grey Coating			Black Coating (EP)		
	PG	NPT	Metric	PG Part #	NPT Part #	Metric Part #	PG Part #	NPT Part #	Metric Part #
Top Entry	16	1/2"	20	10.0409	10.0409 NP	19.0409	70.0490	70.0490 NP	79.0490
	21	3/4"	25	10.0407	10.0407 NP	19.0407	70.0496	70.0496 NP	79.0496
Side Entry	16	1/2"	20	10.0429	10.0429 NP	19.0429	70.0590	70.0590 NP	79.0590
	21	3/4"	25	10.0428	10.0428 NP	19.0428	70.0596	70.0596 NP	79.0596

Metric hoods do not come with a neck.

HIGH PROFILE HOODS

TOP ENTRY

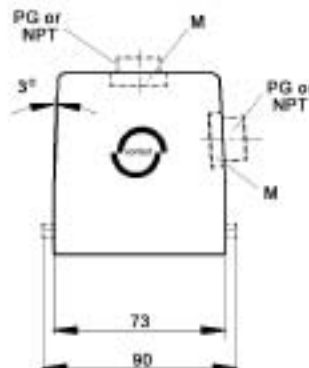
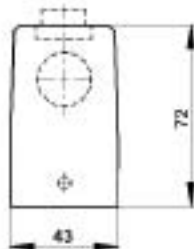

SIDE ENTRY



All dimensions are in mm.

Position of Cable Entry	Size of Entry			Standard Grey Coating			Black Coating (EP)		
	PG	NPT	Metric	PG Part #	NPT Part #	Metric Part #	PG Part #	NPT Part #	Metric Part #
Top Entry	21	3/4"	25	70.0442	70.0442 NP	79.0442	70.0492	70.0492 NP	79.0492
	29	1"	32	70.0444	70.0444 NP	79.0444	70.0494	70.0494 NP	79.0494
Side Entry	21	3/4"	25	70.0542	70.0542 NP	79.0542	70.0592	70.0592 NP	79.0592
	29	1"	32	70.0544	70.0544 NP	79.0544	70.0594	70.0594 NP	79.0594

Metric hoods do not come with a neck.

EPIC® CONNECTORS

HBE 10 Housings: Single Lever on Base



PANEL MOUNT BASES

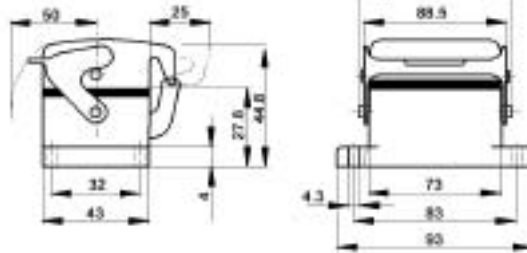

All dimensions are in mm.

Description	Standard Grey Coating	Black Coating (EP)
Panel Mount without Dust Cover	10.0329	70.0327
Panel Mount with Dust Cover	10.0339	70.0337

SURFACE MOUNT BASES

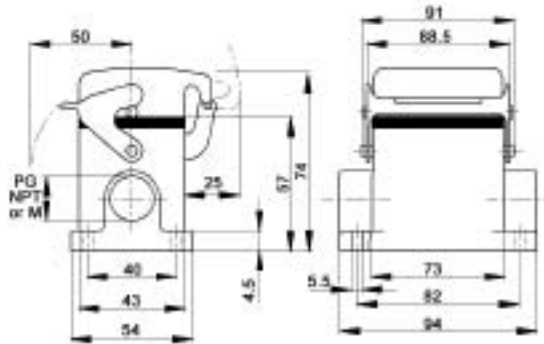
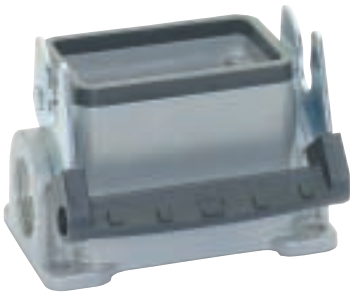

All dimensions are in mm.

# of Entries	Size of Entry			Standard Grey Coating			Black Coating (EP)		
	PG	NPT	Metric	PG Part #	NPT Part #	Metric Part #	PG Part #	NPT Part #	Metric Part #
2 Entries	16	1/2"	20	10.0359	10.0359 NP	19.0359	70.0630	70.0630 NP	79.0630
			25	-	-	79.0616	-	-	79.0636
1 Entry	16	1/2"	20	10.0349	10.0349 NP	19.0349	70.0620	70.0620 NP	79.0620
			25	10.0347	10.0347 NP	19.0347	-	-	79.0626
2 Entries with dust cover	16	1/2"	20	10.0389	10.0389 NP	19.0389	70.0670	70.0670 NP	79.0670
			25	-	-	79.0656	-	-	79.0676
1 Entry with dust cover	16	1/2"	20	10.0369	10.0369 NP	19.0369	70.0660	70.0660 NP	79.0660
			25	-	-	79.0646	-	-	79.0666

DUST COVERS WITH ATTACHMENT STRING



Material: Thermoplastic Resin Temperature: -40°C to 125°C

	Part #
Dust cover with single lever for HBE 10 Hoods	10.0486
Dust cover with single lever bolts for HBE 10 Panel Mount or Surface Mount Base/ Cable Coupler Hood	10.0487

EPIC® CONNECTORS

HBE 10 Housings: Single Lever on Base



HIGH PROFILE SURFACE MOUNT BASES

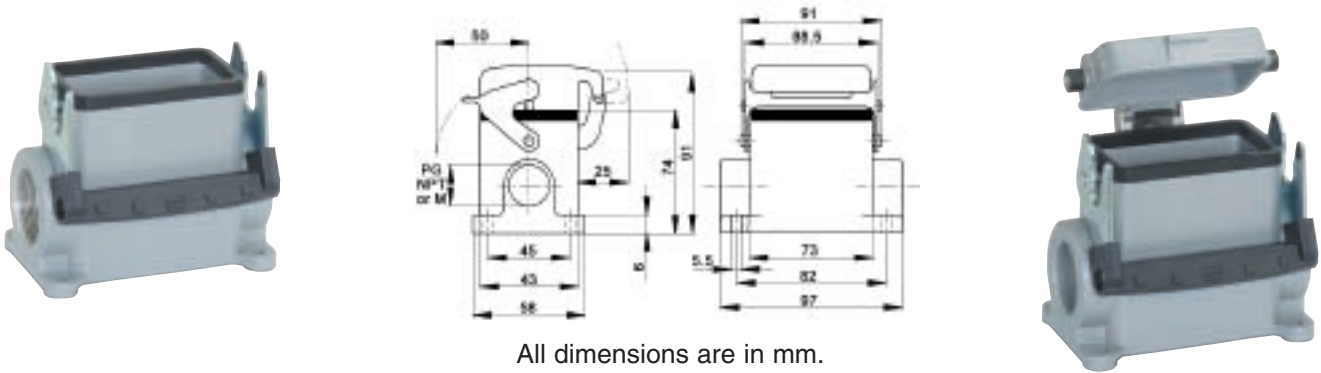

All dimensions are in mm.

# of Entries	Size of Entry			Standard Grey Coating			Black Coating (EP)		
	PG	NPT	Metric	PG Part #	NPT Part #	Metric Part #	PG Part #	NPT Part #	Metric Part #
2 Entries	21	3/4"	25	70.0612	70.0612 NP	79.0612	70.0632	70.0632 NP	79.0632
	29	1"	32	70.0614	70.0614 NP	79.0614	70.0634	70.0634 NP	79.0634
1 Entry	21	3/4"	25	70.0602	70.0602 NP	79.0602	70.0622	70.0622 NP	79.0622
	29	1"	32	70.0604	70.0604 NP	79.0604	70.0624	70.0624 NP	79.0624
2 Entries with dust cover	21	3/4"	25	70.0652	70.0652 NP	79.0652	70.0672	70.0672 NP	79.0672
	29	1"	32	70.0654	70.0654 NP	79.0654	70.0674	70.0674 NP	79.0674
1 Entry with dust cover	21	3/4"	25	70.0642	70.0642 NP	79.0642	70.0662	70.0662 NP	79.0662
	29	1"	32	70.0644	70.0644 NP	79.0644	70.0664	70.0664 NP	79.0664

CABLE COUPLER HOODS

STANDARD PROFILE

HIGH PROFILE



Profile	Size of Entry			Standard Grey Coating			Black Coating (EP)		
	PG	NPT	Metric	PG Part #	NPT Part #	Metric Part #	PG Part #	NPT Part #	Metric Part #
Standard Profile	16	1/2"	20	10.0469	10.0469 NP	19.0469	70.0430	70.0430 NP	79.0430
	21	3/4"	25	70.0422	70.0422 NP	79.0422	70.0432	70.0432 NP	79.0432
High Profile	21	3/4"	25	70.0424	70.0424 NP	79.0424	70.0434	70.0434 NP	79.0434
	29	1"	32	70.0426	70.0426 NP	79.0426	70.0436	70.0436 NP	79.0436

Metric hoods do not come with a neck.

EPIC® CONNECTORS

HBE 10 Housings: Double Levers on Base



HOODS

TOP ENTRY

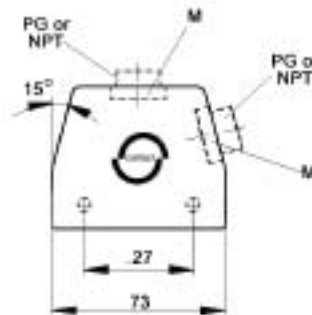
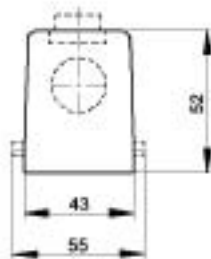

SIDE ENTRY



All dimensions are in mm.

Position of Cable Entry	Size of Entry			Standard Grey Coating			Black Coating (EP)		
	PG	NPT	Metric	PG Part #	NPT Part #	Metric Part #	PG Part #	NPT Part #	Metric Part #
Top Entry	16	1/2"	20	10.0400	10.0400 NP	19.0400	70.0510	70.0510 NP	79.0510
	21	3/4"	25	10.0401	10.0401 NP	19.0401	70.0512	70.0512 NP	79.0512
Side Entry	16	1/2"	20	10.0420	10.0420 NP	19.0420	70.0530	70.0530 NP	79.0530
	21	3/4"	25	10.0421	10.0421 NP	19.0421	70.0532	70.0532 NP	79.0532

Metric hoods do not come with a neck.

HIGH PROFILE HOODS

TOP ENTRY

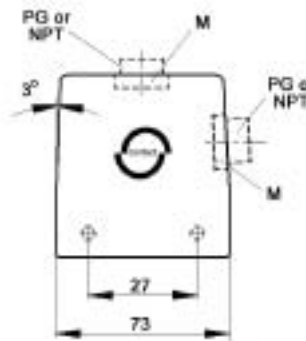
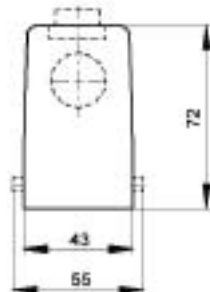

SIDE ENTRY



All dimensions are in mm.

Position of Cable Entry	Size of Entry			Standard Grey Coating			Black Coating (EP)		
	PG	NPT	Metric	PG Part #	NPT Part #	Metric Part #	PG Part #	NPT Part #	Metric Part #
Top Entry	21	3/4"	25	70.0504	70.0504 NP	79.0504	70.0514	70.0514 NP	79.0514
	29	1"	32	70.0506	70.0506 NP	79.0506	70.0516	70.0516 NP	79.0516
Side Entry	21	3/4"	25	70.0524	70.0524 NP	79.0524	70.0534	70.0534 NP	79.0534
	29	1"	32	70.0526	70.0526 NP	79.0526	70.0536	70.0536 NP	79.0536

Metric hoods do not come with a neck.

EPIC[®] CONNECTORS

HBE 10 Housings: Double Levers on Base



PANEL MOUNT BASES

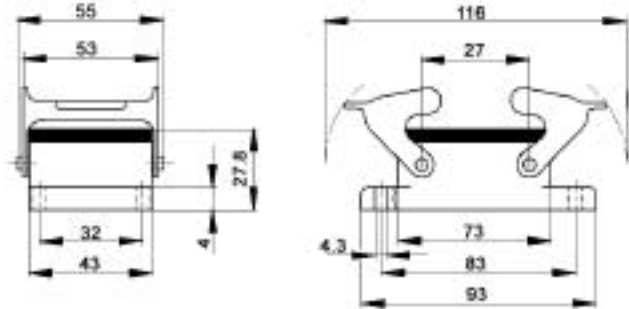
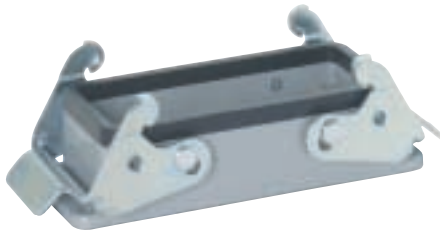

All dimensions are in mm.

Description	Standard Grey Coating	Black Coating (EP)
Panel Mount without Dust Cover	10.0320	70.0325

SURFACE MOUNT BASES

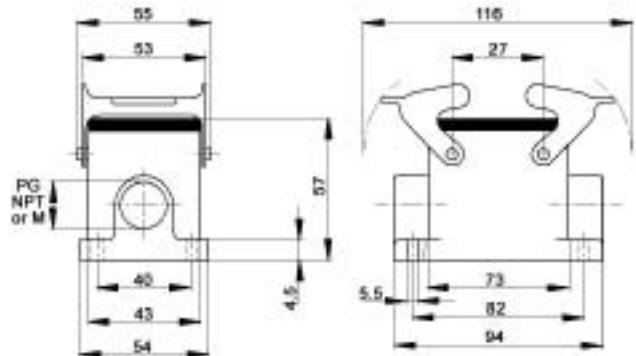

All dimensions are in mm.

# of Entries	Size of Entry			Standard Grey Coating			Black Coating (EP)		
	PG	NPT	Metric	PG Part #	NPT Part #	Metric Part #	PG Part #	NPT Part #	Metric Part #
2 Entries	16	1/2"	20	10.0350	10.0350	NP 19.0350	70.0380	70.0380	NP 79.0380
without cover	-	-	25	-	-	19.0351	-	-	79.0386
1 Entry	16	1/2"	20	10.0340	10.0340	NP 19.0340	70.0370	70.0370	NP 79.0370
without cover	-	-	25	-	-	19.0341	-	-	79.0376

DUST COVERS WITH ATTACHMENT STRING



Material: Thermoplastic Resin **Temperature:** -40°C to 125°C

	Part #
Dust cover with double levers and gasket for HBE 10 Hoods	10.0485
Dust cover with double lever bolts for HBE 10 Panel Mount or Surface Mount Base/ Cable Coupler Hood	10.0470
Dust cover with double lever bolts and gasket for HBE 10 Hoods	10.0471

EPIC® CONNECTORS

HBE 10 Housings: Double Levers on Base



HIGH PROFILE SURFACE MOUNT BASES

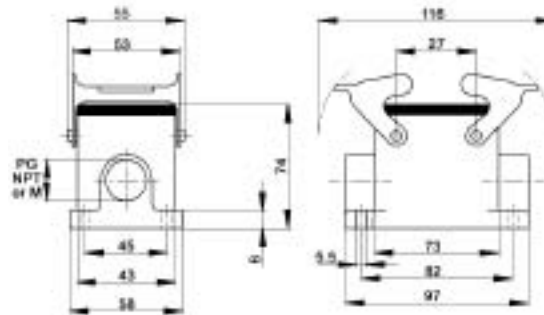
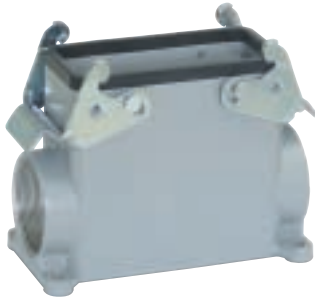

All dimensions are in mm.

# of Entries	Size of Entry			Standard Grey Coating			Black Coating (EP)		
	PG	NPT	Metric	PG Part #	NPT Part #	Metric Part #	PG Part #	NPT Part #	Metric Part #
2 Entries without cover	21	3/4"	25	70.0362	70.0362 NP	79.0362	70.0382	70.0382 NP	79.0382
	29	1"	32	70.0364	70.0364 NP	79.0364	70.0384	70.0384 NP	79.0384
1 Entry without cover	21	3/4"	25	70.0352	70.0352 NP	79.0352	70.0372	70.0372 NP	79.0372
	29	1"	32	70.0354	70.0354 NP	79.0354	70.0374	70.0374 NP	79.0374

CABLE COUPLER HOODS

STANDARD PROFILE

HIGH PROFILE

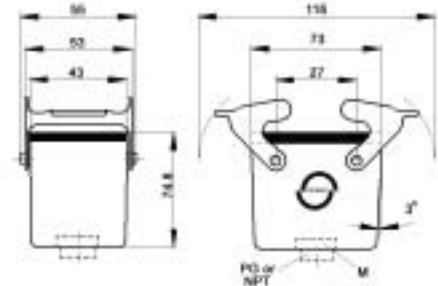
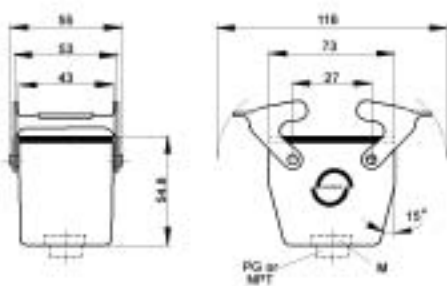

All dimensions are in mm.

Profile	Size of Entry			Standard Grey Coating			Black Coating (EP)		
	PG	NPT	Metric	PG Part #	NPT Part #	Metric Part #	PG Part #	NPT Part #	Metric Part #
Standard Profile	16	1/2"	20	10.0460	10.0460 NP	19.0460	70.0410	70.0410 NP	79.0410
	21	3/4"	25	70.0402	70.0402 NP	79.0402	70.0412	70.0412 NP	79.0412
High Profile	21	3/4"	25	70.0404	70.0404 NP	79.0404	70.0414	70.0414 NP	79.0414
	29	1"	32	70.0406	70.0406 NP	79.0406	70.0416	70.0416 NP	79.0416

Metric hoods do not come with a neck.

EPIC[®] CONNECTORS

HBE 10 Housings: Double Levers on Hood



HOODS

TOP ENTRY

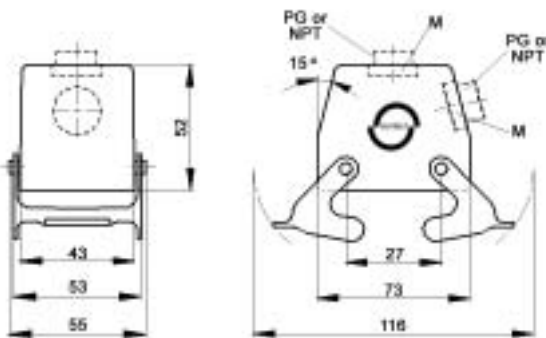

SIDE ENTRY



All dimensions are in mm.

Position of Cable Entry	Size of Entry			Standard Grey Coating			Black Coating (EP)		
	PG	NPT	Metric	PG Part #	NPT Part #	Metric Part #	PG Part #	NPT Part #	Metric Part #
Top Entry	16	1/2"	20	10.0410	10.0410 NP	19.0410	70.0560	70.0560 NP	79.0560
	-	-	25	-	-	79.0557	-	-	79.0566
Side Entry	16	1/2"	20	10.0450	10.0450 NP	19.0450	70.0580	70.0580 NP	79.0580
	-	-	25	-	-	79.0577	-	-	79.0586

Metric hoods do not come with a neck.

HIGH PROFILE HOODS

TOP ENTRY

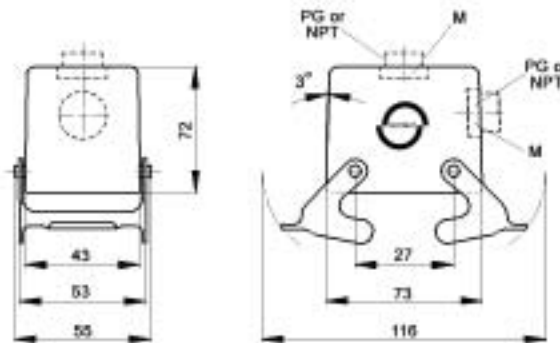

SIDE ENTRY



All dimensions are in mm.

Position of Cable Entry	Size of Entry			Standard Grey Coating			Black Coating (EP)		
	PG	NPT	Metric	PG Part #	NPT Part #	Metric Part #	PG Part #	NPT Part #	Metric Part #
Top Entry	21	3/4"	25	70.0552	70.0552 NP	79.0552	70.0562	70.0562 NP	79.0562
	29	1"	32	70.0554	70.0554 NP	79.0554	70.0564	70.0564 NP	79.0564
Side Entry	21	3/4"	25	70.0572	70.0572 NP	79.0572	70.0582	70.0582 NP	79.0582
	29	1"	32	70.0574	70.0574 NP	79.0574	70.0584	70.0584 NP	79.0584

Metric hoods do not come with a neck.

EPIC® CONNECTORS

HBE 10 Housings: Double Levers on Hood



PANEL MOUNT BASES

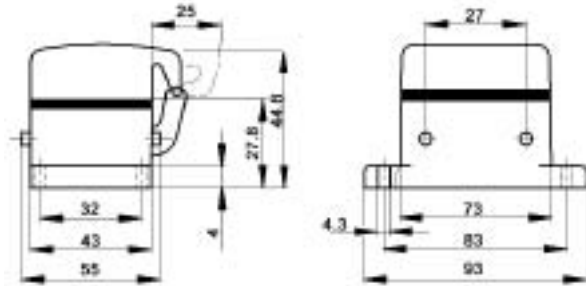

All dimensions are in mm.

Description	Standard Grey Coating	Black Coating (EP)
Panel Mount with Dust Cover	10.0330	70.0335

SURFACE MOUNT BASES

STANDARD PROFILE

HIGH PROFILE

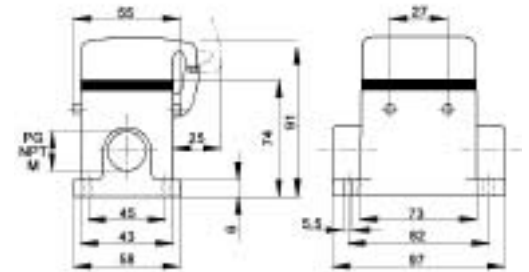
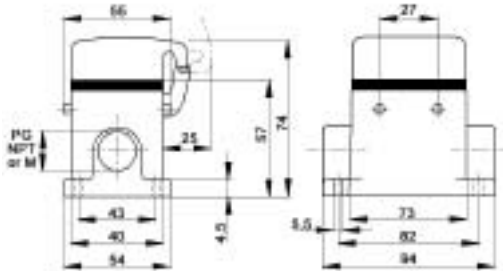

All dimensions are in mm.

STANDARD PROFILE

# of Entries	Size of Entry			Standard Grey Coating			Black Coating (EP)		
	PG	NPT	Metric	PG Part #	NPT Part #	Metric Part #	PG Part #	NPT Part #	Metric Part #
2 Entries with Dust Cover	16	1/2"	20	10.0380	10.0380 NP	19.0380	70.0480	70.0480 NP	79.0480
	-	-	25	-	-	79.0466	-	-	79.0486
1 Entry with Dust Cover	16	1/2"	20	10.0360	10.0360 NP	19.0360	70.0470	70.0470 NP	79.0470
	-	-	25	-	-	19.0361	-	-	79.0476

HIGH PROFILE

# of Entries	Size of Entry			Standard Grey Coating			Black Coating (EP)		
	PG	NPT	Metric	PG Part #	NPT Part #	Metric Part #	PG Part #	NPT Part #	Metric Part #
2 Entries with Dust Cover	21	3/4"	25	70.0462	70.0462 NP	79.0462	70.0482	70.0482 NP	79.0482
	29	1"	32	70.0464	70.0464 NP	79.0464	70.0484	70.0484 NP	79.0484
1 Entry with Dust Cover	21	3/4"	25	70.0452	70.0452 NP	79.0452	70.0472	70.0472 NP	79.0472
	29	1"	32	70.0454	70.0454 NP	79.0454	70.0474	70.0474 NP	79.0474

EPIC® CONNECTORS

HBE 16 Plugs & Receptacles



SCREW & CRIMP TERMINATED INSERTS

SCREW TERMINATED

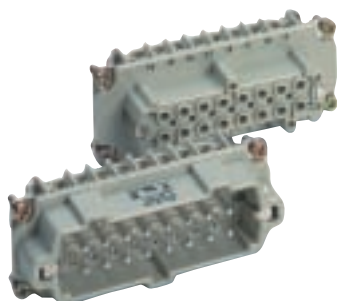

View from Cable Side

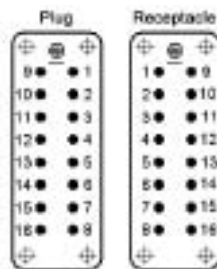

CRIMP TERMINATED



Panel Cut-Out
(Insert Only)

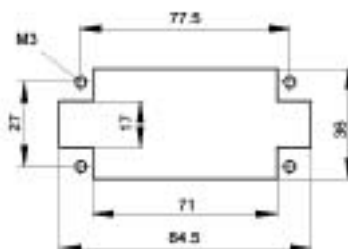

Contacts Sold Separately

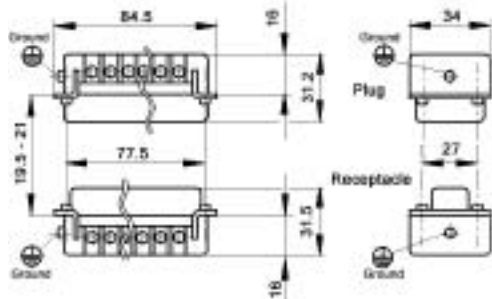
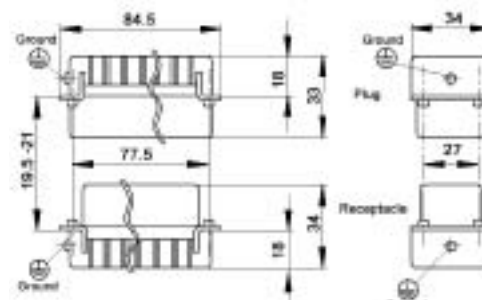

All dimensions are in mm.

These inserts fit in the HBE 16 Series Housings.

	Plug	Receptacle
Screw Terminated: with wire protection	10.1940	10.1950
Screw Terminated: without wire protection	10.1941	10.1951
Crimp Terminated: Machine	10.1840	10.1850

Crimp Contacts are on the next page.

SCREWLESS SPRING CAGE CLAMP INSERTS

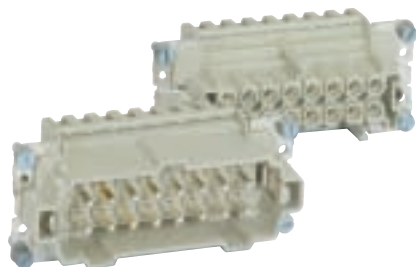

Panel Cut-Out
(Insert Only)

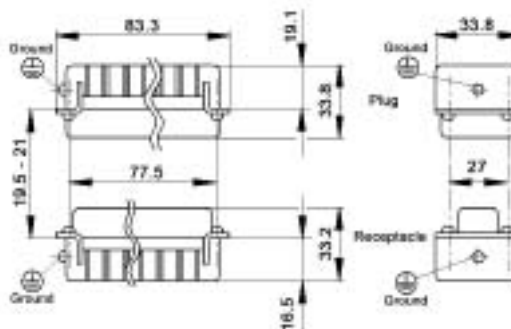

All dimensions are in mm.

Same View from Cable Side as Screw & Crimp Termination

	Plug	Receptacle
Screwless Cage Clamp	10.4002	10.4012

These inserts fit in the HBE 16 Series Housings.

EPIC® CONNECTORS

Accessories for Crimp Terminated Inserts



SCREW TERMINATED TERMINAL BLOCK INSERTS

View from Cable Side

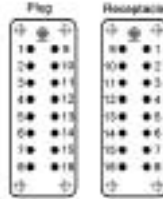
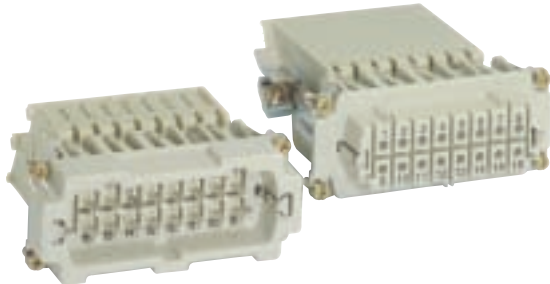

All dimensions are in mm.

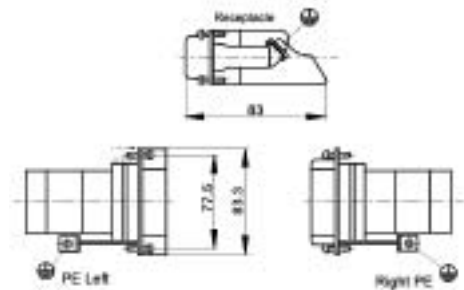

These terminal block inserts only fit in HBE 16 panel mount bases

	Receptacle
Terminal Block: Right Ground	70.3151
Terminal Block: Left Ground	70.3141

One terminal block insert mates with one screw terminated insert.

MACHINED CONTACTS: DIAMETER 2.5 MM²

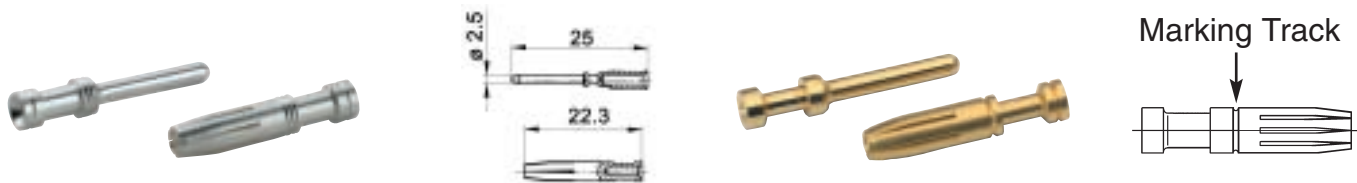

Bags of 100

mm ²	AWG	Silver		Gold		Stripping Length (mm)	# of Marking Tracks
		Pin	Socket	Pin	Socket		
0.5	20	11.1900	11.1950	11.1920	11.1970	Pin=7.4, Socket =7.3	-
.75 - 1.0	18	11.1901	11.1951	11.1921	11.1971	Pin=7.4, Socket =7.3	1
1.5	16	11.1902	11.1952	11.1922	11.1972	Pin=7.4, Socket =7.3	2
2.5	14	11.1903	11.1953	-	-	Pin=7.4, Socket =7.3	3
4.0	12	11.1904	11.1954	-	-	Pin=7.4, Socket =7.3	-

Part number= 1 contact

CRIMP TOOLS

Wire Gauge: 0.5 - 4.0 mm² for the HBE Crimp Inserts



Locator
11.1472



Crimp Tool
11.1470



Crimp Dies
11.1471

For removal of contacts use a slotted screwdriver. No special tool is necessary.

Please note that the crimp range for this tool is 0.14 to 2.5 mm² (AWG 26 - 14) with the appropriate crimp dies.

EPIC® CONNECTORS

HBE 16 Housings: Single Lever on Base



HOODS

TOP ENTRY

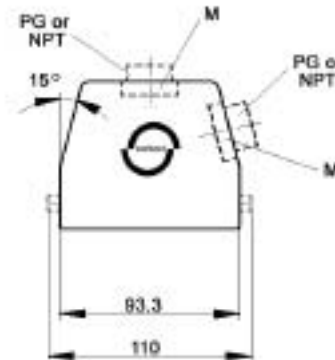
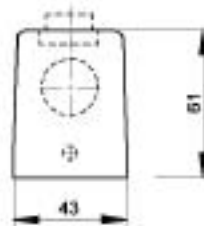

SIDE ENTRY



All dimensions are in mm.

Position of Cable Entry	Size of Entry			Standard Grey Coating			Black Coating (EP)		
	PG	NPT	Metric	PG Part #	NPT Part #	Metric Part #	PG Part #	NPT Part #	Metric Part #
Top Entry	21	3/4"	25	10.0809	10.0809 NP	19.0809	70.0990	70.0990 NP	79.0990
	29	1"	32	10.0909	10.0909 NP	19.0909	-	-	-
Side Entry	21	3/4"	25	10.0829	10.0829 NP	19.0829	70.1090	70.1090 NP	79.1090
	29	1"	32	10.0929	10.0929 NP	19.0929	-	-	-

Metric hoods do not come with a neck.

HIGH PROFILE HOODS

TOP ENTRY

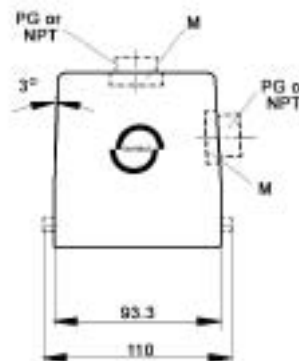
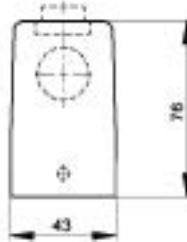

SIDE ENTRY



All dimensions are in mm.

Position of Cable Entry	Size of Entry			Standard Grey Coating			Black Coating (EP)		
	PG	NPT	Metric	PG Part #	NPT Part #	Metric Part #	PG Part #	NPT Part #	Metric Part #
Top Entry	21	3/4"	25	70.0942	70.0942 NP	79.0942	70.0992	70.0992 NP	79.0992
	29	1"	32	70.0944	70.0944 NP	79.0944	70.0994	70.0994 NP	79.0994
	-	-	40	-	-	79.0946	-	-	-
Side Entry	21	3/4"	25	70.1042	70.1042 NP	79.1042	70.1092	70.1092 NP	79.1092
	29	1"	32	70.1044	70.1044 NP	79.1044	70.1094	70.1094 NP	79.1094
	-	-	40	-	-	79.1048	-	-	-

Metric hoods do not come with a neck.

EPIC® CONNECTORS

HBE 16 Housings: Single Lever on Base



PANEL MOUNT BASES

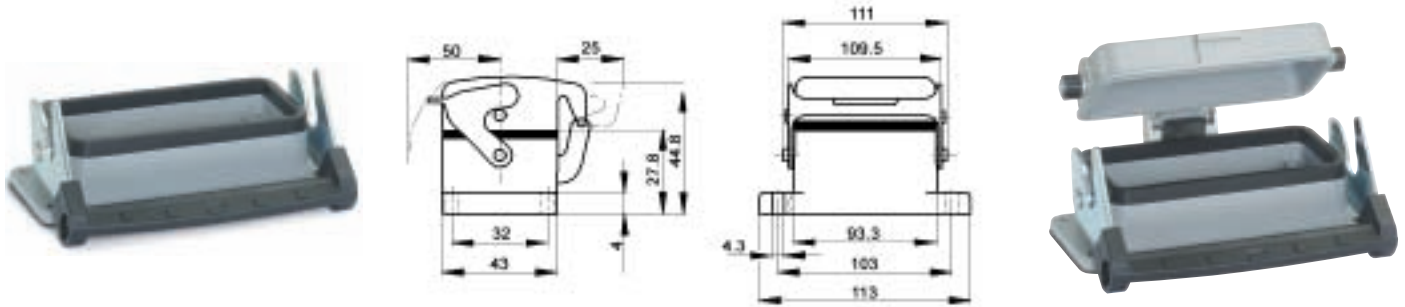

All dimensions are in mm.

Description	Standard Grey Coating	Black Coating (EP)
Panel Mount without Dust Cover	10.0729	70.0827
Panel Mount with Dust Cover	10.0739	70.0837

SURFACE MOUNT BASES

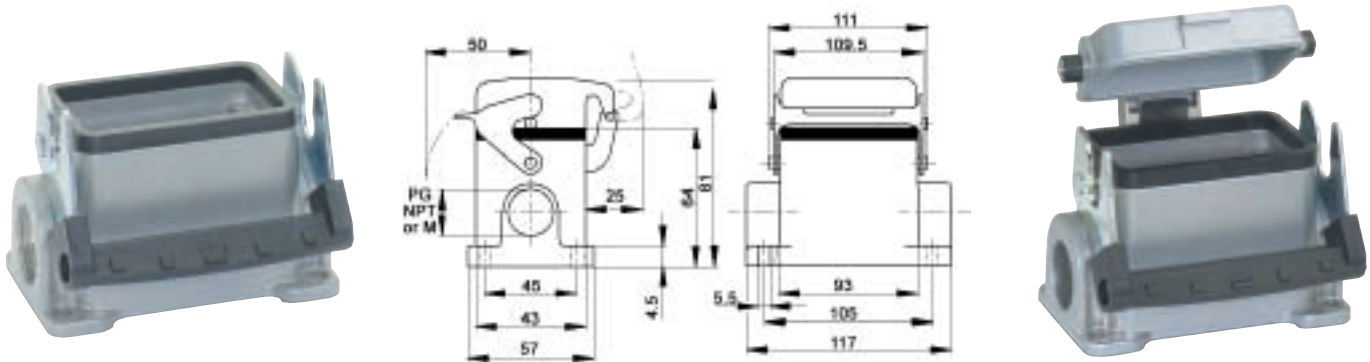

All dimensions are in mm.

# of Entries	Size of Entry			Standard Grey Coating			Black Coating (EP)		
	PG	NPT	Metric	PG Part #	NPT Part #	Metric Part #	PG Part #	NPT Part #	Metric Part #
2 Entries	21	3/4"	25	10.0759	10.0759 NP	19.0759	70.1130	70.1130 NP	79.1130
1 Entry	21	3/4"	25	10.0749	10.0749 NP	19.0749	70.1120	70.1120 NP	79.1120
2 Entries with dust cover	21	3/4"	25	10.0789	10.0789 NP	19.0789	70.1170	70.1170 NP	79.1170
1 Entry with dust cover	21	3/4"	25	10.0769	10.0769 NP	19.0769	70.1160	70.1160 NP	79.1160

DUST COVERS WITH ATTACHMENT STRING



Material:	Thermoplastic Resin	Temperature:	-40°C to 125°C
			Part #
Dust cover with single lever for HBE 16 Hoods			10.0886
Dust cover with single lever bolts for HBE 16 Panel Mount or Surface Mount Base/ Cable Coupler Hood			10.0887

EPIC® CONNECTORS

HBE 16 Housings: Single Lever on Base



HIGH PROFILE SURFACE MOUNT BASES

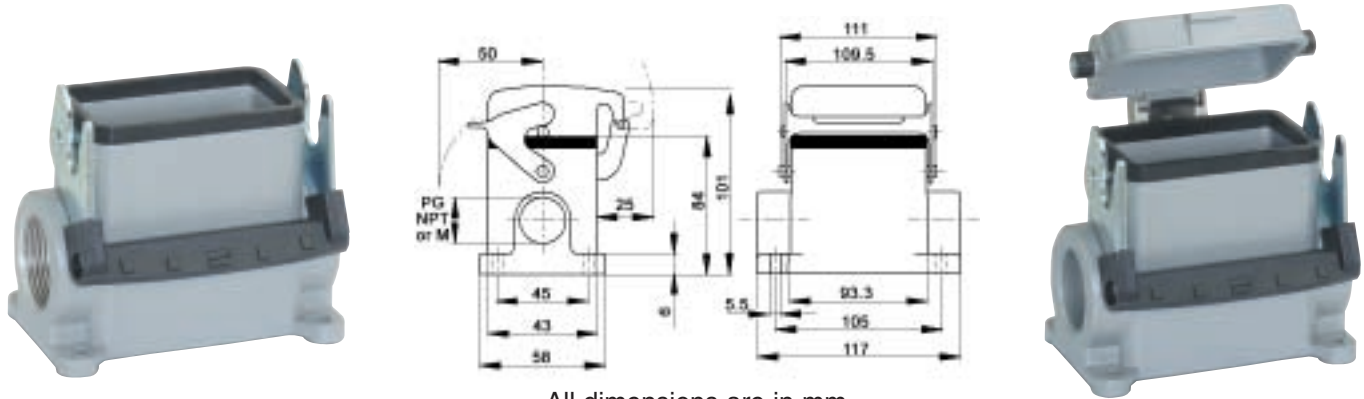

All dimensions are in mm.

# of Entries	Size of Entry			Standard Grey Coating			Black Coating (EP)		
	PG	NPT	Metric	PG Part #	NPT Part #	Metric Part #	PG Part #	NPT Part #	Metric Part #
2 Entries	21	3/4"	25	70.1112	70.1112 NP	79.1112	70.1132	70.1132 NP	79.1132
	29	1"	32	70.1114	70.1114 NP	79.1114	70.1134	70.1134 NP	79.1134
1 Entry	21	3/4"	25	70.1102	70.1102 NP	79.1102	70.1122	70.1122 NP	79.1122
	29	1"	32	70.1104	70.1104 NP	79.1104	70.1124	70.1124 NP	79.1124
2 Entries with dust cover	21	3/4"	25	70.1152	70.1152 NP	79.1152	70.1172	70.1172 NP	79.1172
	29	1"	32	70.1154	70.1154 NP	79.1154	70.1174	70.1174 NP	79.1174
1 Entry with dust cover	21	3/4"	25	70.1142	70.1142 NP	79.1142	70.1162	70.1162 NP	79.1162
	29	1"	32	70.1144	70.1144 NP	79.1144	70.1164	70.1164 NP	79.1164

CABLE COUPLER HOODS

STANDARD PROFILE

HIGH PROFILE



All dimensions are in mm.

Profile	Size of Entry			Standard Grey Coating			Black Coating (EP)		
	PG	NPT	Metric	PG Part #	NPT Part #	Metric Part #	PG Part #	NPT Part #	Metric Part #
Standard Profile	21	3/4"	25	10.0869	10.0869 NP	19.0869	70.0930	70.0930 NP	79.0930
	29	1"	32	10.0969	10.0969 NP	19.0969	-	-	-
High Profile	21	3/4"	25	70.0922	70.0922 NP	79.0922	70.0932	70.0932 NP	79.0932
	29	1"	32	70.0924	70.0924 NP	79.0924	70.0934	70.0934 NP	79.0934

Metric hoods do not come with a neck.

EPIC® CONNECTORS

HBE 16 Housings: Double Levers on Base



HOODS

TOP ENTRY

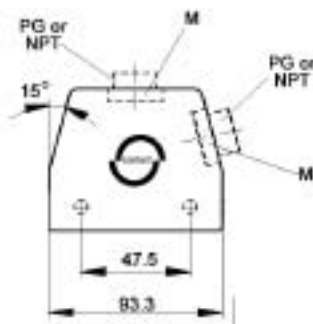
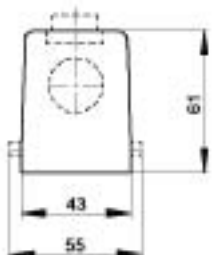

SIDE ENTRY



All dimensions are in mm.

Position of Cable Entry	Size of Entry			Standard Grey Coating			Black Coating (EP)		
	PG	NPT	Metric	PG Part #	NPT Part #	Metric Part #	PG Part #	NPT Part #	Metric Part #
Top Entry	21	3/4"	25	10.0800	10.0800 NP	19.0800	70.1010	70.1010 NP	79.1010
	29	1"	32	10.0900	10.0900 NP	19.0900	-	-	-
Side Entry	21	3/4"	25	10.0820	10.0820 NP	19.0820	70.1030	70.1030 NP	79.1030
	29	1"	32	10.0920	10.0920 NP	19.0920	-	-	-

Metric hoods do not come with a neck.

HIGH PROFILE HOODS

TOP ENTRY

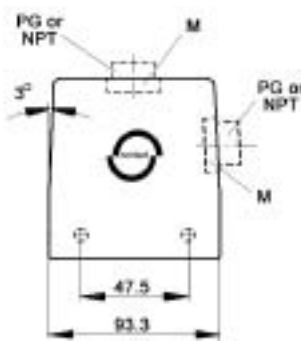
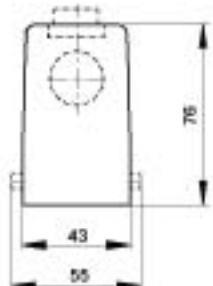

SIDE ENTRY



All dimensions are in mm.

Position of Cable Entry	Size of Entry			Standard Grey Coating			Black Coating (EP)		
	PG	NPT	Metric	PG Part #	NPT Part #	Metric Part #	PG Part #	NPT Part #	Metric Part #
Top Entry	21	3/4"	25	70.1002	70.1002 NP	79.1002	70.1012	70.1012 NP	79.1012
	29	1"	32	70.1004	70.1004 NP	79.1004	70.1014	70.1014 NP	79.1014
	-	-	40	-	-	79.1008	-	-	-
Side Entry	21	3/4"	25	70.1022	70.1022 NP	79.1022	70.1032	70.1032 NP	79.1032
	29	1"	32	70.1024	70.1024 NP	79.1024	70.1034	70.1034 NP	79.1034
	-	-	40	-	-	79.1028	-	-	-

Metric hoods do not come with a neck.

EPIC[®] CONNECTORS

HBE 16 Housings: Double Levers on Base



PANEL MOUNT BASES

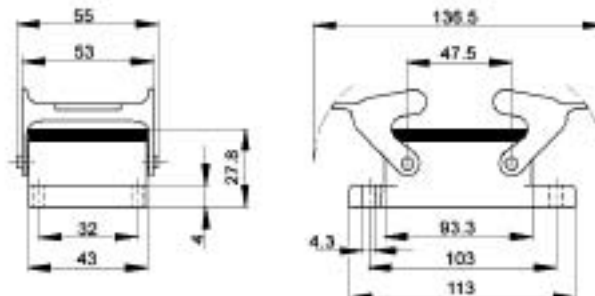

All dimensions are in mm.

Description	Standard Grey Coating	Black Coating (EP)
Panel Mount without Dust Cover	10.0720	70.0825

SURFACE MOUNT BASES

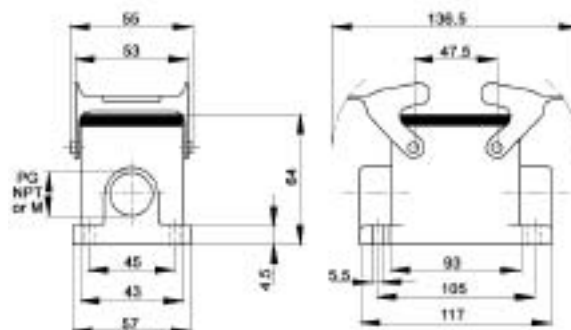

All dimensions are in mm.

# of Entries	Size of Entry			Standard Grey Coating			Black Coating (EP)		
	PG	NPT	Metric	PG Part #	NPT Part #	Metric Part #	PG Part #	NPT Part #	Metric Part #
2 Entries	21	3/4"	25	10.0750	10.0750 NP	19.0750	70.0880	70.0880 NP	79.0880
1 Entry	21	3/4"	25	10.0740	10.0740 NP	19.0740	70.0870	70.0870 NP	79.0870

DUST COVERS WITH ATTACHMENT STRING



Material: Thermoplastic Resin

Temperature: -40°C to 125°C

	Part #
Dust cover with double levers and gasket for HBE 16 Hoods	10.0885
Dust cover with double lever bolts for HBE 16 Panel Mount or Surface Mount Base/ Cable Coupler Hood	10.0870

EPIC® CONNECTORS

HBE 16 Housings: Double Levers on Base



HIGH PROFILE SURFACE MOUNT BASES

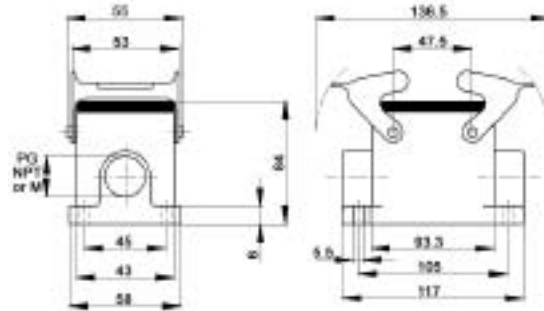

All dimensions are in mm.

# of Entries	Size of Entry			Standard Grey Coating			Black Coating (EP)		
	PG	NPT	Metric	PG Part #	NPT Part #	Metric Part #	PG Part #	NPT Part #	Metric Part #
2 Entries	21	3/4"	25	70.0862	70.0862 NP	79.0862	70.0882	70.0882 NP	79.0882
	29	1"	32	70.0864	70.0864 NP	79.0864	70.0884	70.0884 NP	79.0884
1 Entry	21	3/4"	25	70.0852	70.0852 NP	79.0852	70.0872	70.0872 NP	79.0872
	29	1"	32	70.0854	70.0854 NP	79.0854	70.0874	70.0874 NP	79.0874

CABLE COUPLER HOODS

STANDARD PROFILE

HIGH PROFILE

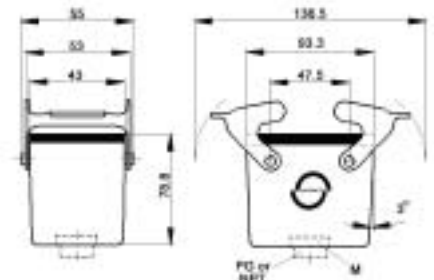
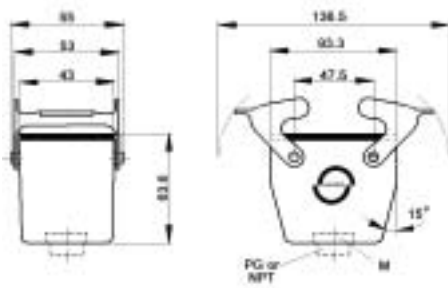

All dimensions are in mm.

Profile	Size of Entry			Standard Grey Coating			Black Coating (EP)		
	PG	NPT	Metric	PG Part #	NPT Part #	Metric Part #	PG Part #	NPT Part #	Metric Part #
Standard Profile	21	3/4"	25	10.0860	10.0860 NP	19.0860	70.0910	70.0910 NP	79.0910
	29	1"	32	10.0960	10.0960 NP	-	-	-	-
High Profile	21	3/4"	25	70.0902	70.0902 NP	79.0902	70.0912	70.0912 NP	79.0912
	29	1"	32	70.0904	70.0904 NP	79.0904	70.0914	70.0914 NP	79.0914

Metric hoods do not come with a neck.

EPIC[®] CONNECTORS

HBE 16 Housings: Double Levers on Hood



HOODS

TOP ENTRY

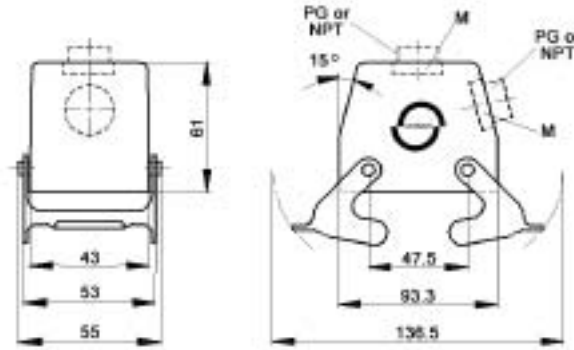

SIDE ENTRY



All dimensions are in mm.

Position of Cable Entry	Size of Entry			Standard Grey Coating			Black Coating (EP)		
	PG	NPT	Metric	PG Part #	NPT Part #	Metric Part #	PG Part #	NPT Part #	Metric Part #
Top Entry	21	3/4"	25	10.0810	10.0810 NP	19.0810	70.1060	70.1060 NP	79.1060
	29	1"	32	10.0910	10.0910 NP	19.0910	-	-	-
Side Entry	21	3/4"	25	10.0830	10.0830 NP	19.0830	70.1080	70.1080 NP	79.1080
	29	1"	32	10.0930	10.0930 NP	19.0930	-	-	-

Metric hoods do not come with a neck.

HIGH PROFILE HOODS

TOP ENTRY

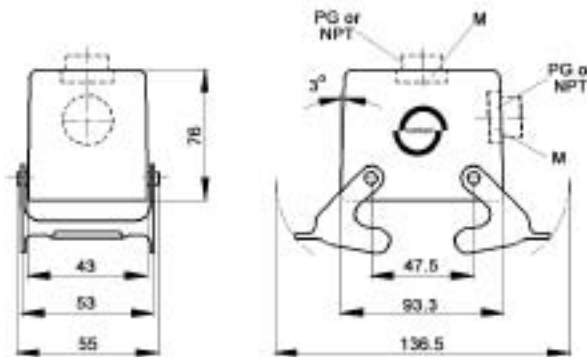

SIDE ENTRY



All dimensions are in mm.

Position of Cable Entry	Size of Entry			Standard Grey Coating			Black Coating (EP)		
	PG	NPT	Metric	PG Part #	NPT Part #	Metric Part #	PG Part #	NPT Part #	Metric Part #
Top Entry	21	3/4"	25	70.1052	70.1052 NP	79.1052	70.1062	70.1062 NP	79.1062
	29	1"	32	70.1054	70.1054 NP	79.1054	70.1064	70.1064 NP	79.1064
Side Entry	21	3/4"	25	70.1072	70.1072 NP	79.1072	70.1082	70.1082 NP	79.1082
	29	1"	32	70.1074	70.1074 NP	79.1074	70.1084	70.1084 NP	79.1084

Metric hoods do not come with a neck.

EPIC® CONNECTORS

HBE 16 Housings: Double Levers on Hood



PANEL MOUNT BASES

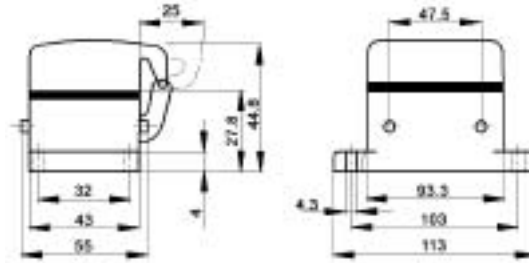

All dimensions are in mm.

Description	Standard Grey Coating	Black Coating (EP)
Panel Mount without Dust Cover	10.0731	-
Panel Mount with Dust Cover	10.0730	70.0835

SURFACE MOUNT BASES

STANDARD PROFILE

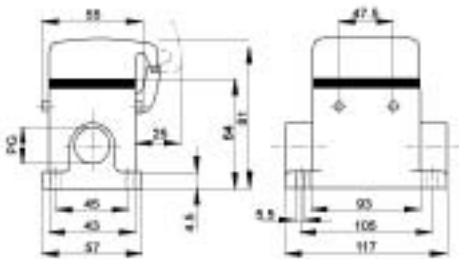

All dimensions are in mm.

HIGH PROFILE

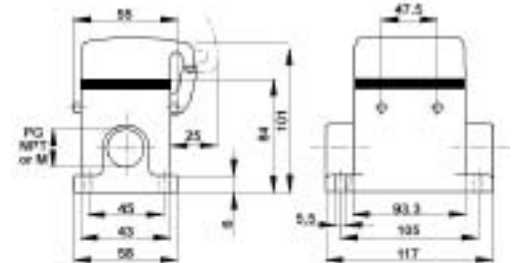

WITH DUST COVER

# of Entries	Size of Entry			Standard Grey Coating			Black Coating (EP)		
	PG	NPT	Metric	PG Part #	NPT Part #	Metric Part #	PG Part #	NPT Part #	Metric Part #
2 Entries	21	3/4"	25	70.0960	70.0960 NP	79.0960	70.0980	70.0980 NP	79.0980
1 Entry	21	3/4"	25	10.0760	10.0760 NP	19.0760	70.0970	70.0970 NP	79.0970
High Profile with 2 Entries	21	3/4"	25	70.0962	70.0962 NP	79.0962	70.0982	70.0982 NP	79.0982
High Profile with 1 Entry	29	1"	32	70.0964	70.0964 NP	79.0964	70.0984	70.0984 NP	79.0984
High Profile with 2 Entries	21	3/4"	25	70.0952	70.0952 NP	79.0952	70.0972	70.0972 NP	79.0972
High Profile with 1 Entry	29	1"	32	70.0954	70.0954 NP	79.0954	70.0974	70.0974 NP	79.0974

DUST COVERS WITH ATTACHMENT STRING



Material: Thermoplastic Resin Temperature: -40°C to 125°C

	Part #
Dust cover with double lever bolts and gasket for HBE 16 Hoods	10.0871

EPIC[®] CONNECTORS

HBE 24 Plugs & Receptacles



SCREW & CRIMP TERMINATED INSERTS

SCREW TERMINATED

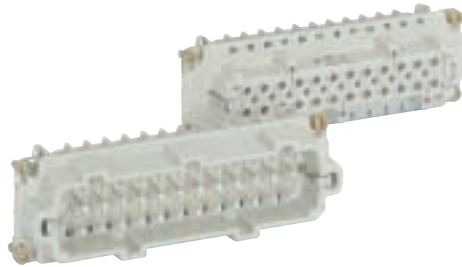

View from Cable Side

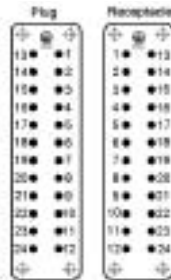

Panel Cut-Out
(Insert Only)

CRIMP TERMINATED

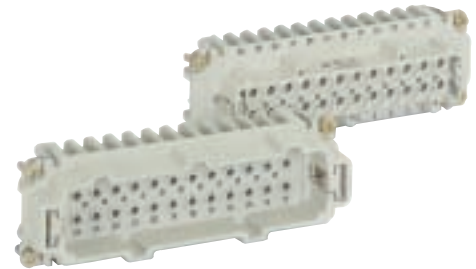

Contacts Sold Separately

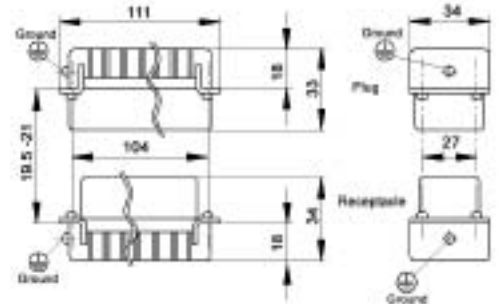
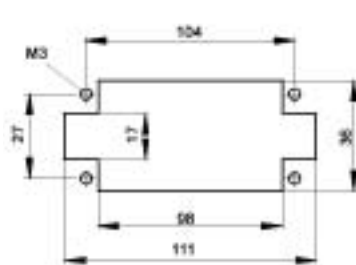
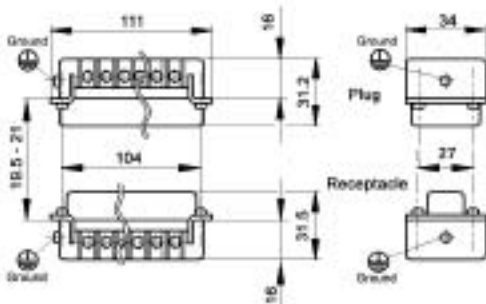

All dimensions are in mm.

These inserts fit in the HBE 24 Series Housings.

	Plug	Receptacle
Screw Terminated: with wire protection	10.1960	10.1970
Screw Terminated: without wire protection	10.1961	10.1971
Crimp Terminated: Machine	10.1860	10.1870

Crimp Contacts are on the next page.

SCREWLESS SPRING CAGE CLAMP INSERTS



Same View from Cable Side as Screw & Crimp Termination

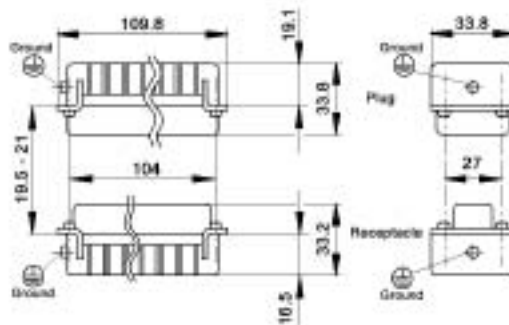

All dimensions are in mm.

Panel Cut-Out
(Insert Only)

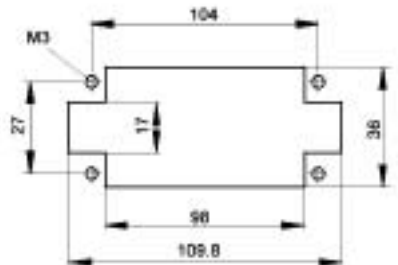

	Plug	Receptacle
Screwless Cage Clamp	10.4003	10.4013

These inserts fit in the HBE 24 Series Housings.

EPIC® CONNECTORS

Accessories for Crimp Terminated Inserts



SCREW TERMINATED TERMINAL BLOCK INSERTS

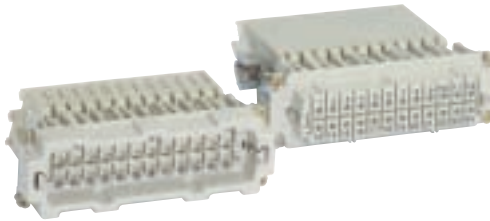

View from Cable Side

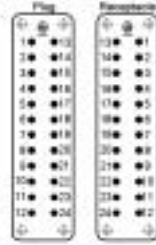

All dimensions are in mm.

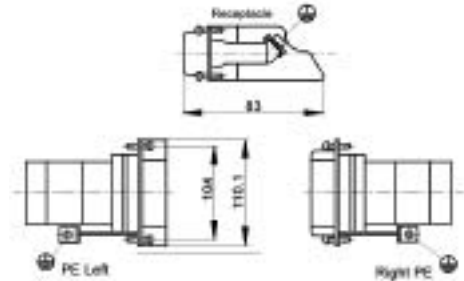

These terminal block inserts only fit in HBE 24 panel mount bases

	Receptacle
Terminal Block: Right Ground	70.3171
Terminal Block: Left Ground	70.3161

One terminal block insert mates with one screw terminated insert.

MACHINED CONTACTS: DIAMETER 2.5 MM²

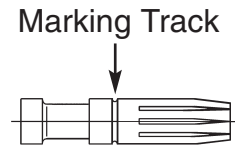
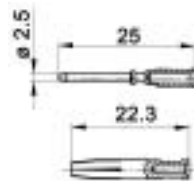

Bags of 100

mm ²	AWG	Silver		Gold		Stripping Length (mm)	# of Marking Tracks
		Pin	Socket	Pin	Socket		
0.5	20	11.1900	11.1950	11.1920	11.1970	Pin=7.4, Socket =7.3	-
.75 - 1.0	18	11.1901	11.1951	11.1921	11.1971	Pin=7.4, Socket =7.3	1
1.5	16	11.1902	11.1952	11.1922	11.1972	Pin=7.4, Socket =7.3	2
2.5	14	11.1903	11.1953	-	-	Pin=7.4, Socket =7.3	3
4.0	12	11.1904	11.1954	-	-	Pin=7.4, Socket =7.3	-

Part number= 1 contact

CRIMP TOOLS

Wire Gauge: 0.5 - 4.0 mm² for the HBE Crimp Inserts



Locator
11.1472



Crimp Tool
11.1470



Crimp Dies
11.1471

For removal of contacts use a slotted screwdriver. No special tool is necessary.

Please note that the crimp range for this tool is 0.14 to 2.5 mm² (AWG 26 - 14) with the appropriate crimp dies.

EPIC[®] CONNECTORS

HBE 24 Housings: Single Lever on Base



HOODS

TOP ENTRY

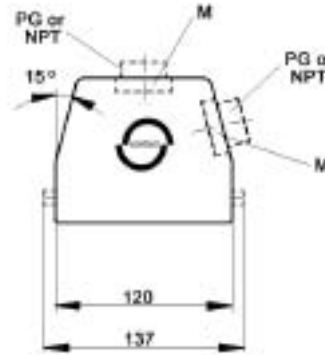

SIDE ENTRY



All dimensions are in mm.

Position of Cable Entry	Size of Entry			Standard Grey Coating			Black Coating (EP)		
	PG	NPT	Metric	PG Part #	NPT Part #	Metric Part #	PG Part #	NPT Part #	Metric Part #
Top Entry	21	3/4"	25	10.1219	10.1219 NP	19.1219	70.1490	70.1490 NP	79.1490
	29	1"	32	10.1119	10.1119 NP	19.1119	70.1492	70.1492 NP	79.1492
Side Entry	21	3/4"	25	10.1139	10.1139 NP	19.1139	70.1590	70.1590 NP	79.1590
	29	1"	32	10.1239	10.1239 NP	19.1239	70.1592	70.1592 NP	79.1592

Metric hoods do not come with a neck.

HIGH PROFILE HOODS

TOP ENTRY

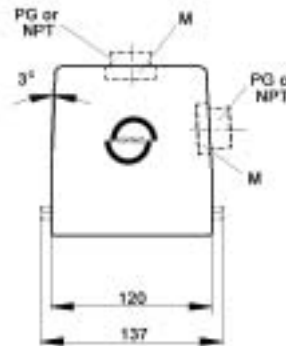
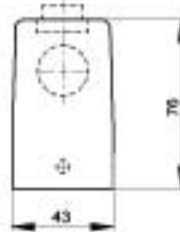

SIDE ENTRY



All dimensions are in mm.

Position of Cable Entry	Size of Entry			Standard Grey Coating			Black Coating (EP)		
	PG	NPT	Metric	PG Part #	NPT Part #	Metric Part #	PG Part #	NPT Part #	Metric Part #
Top Entry	21	3/4"	25	70.1444	70.1444 NP	79.1444	70.1494	70.1494 NP	79.1494
	29	1"	32	70.1446	70.1446 NP	79.1446	70.1496	70.1496 NP	79.1496
	-	-	40	-	-	79.1448	-	-	-
Side Entry	21	3/4"	25	70.1544	70.1544 NP	79.1544	70.1594	70.1594 NP	79.1594
	29	1"	32	70.1546	70.1546 NP	79.1546	70.1596	70.1596 NP	79.1596
	-	-	40	-	-	79.1548	-	-	-

Metric hoods do not come with a neck.

EPIC® CONNECTORS

HBE 24 Housings: Single Lever on Base



PANEL MOUNT BASES

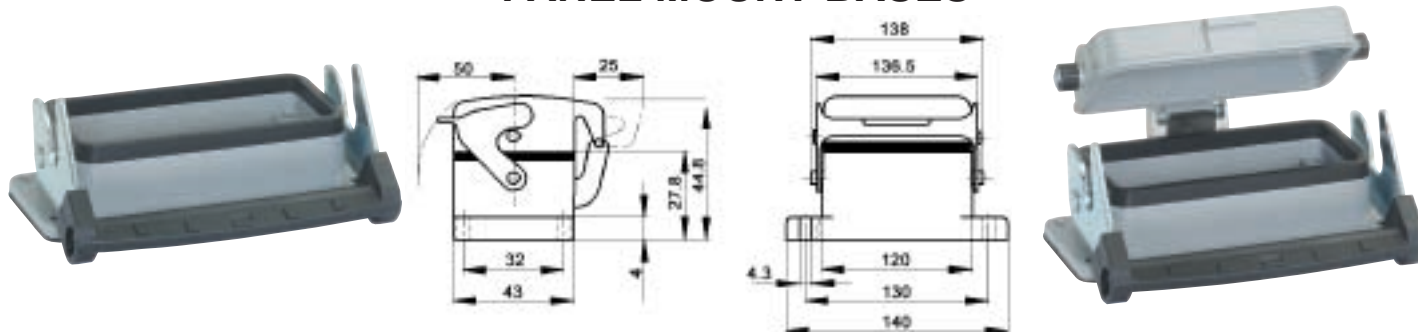

All dimensions are in mm.

Description	Standard Grey Coating	Black Coating (EP)
Panel Mount without Dust Cover	10.1029	70.1327
Panel Mount with Dust Cover	10.1039	70.1337

SURFACE MOUNT BASES

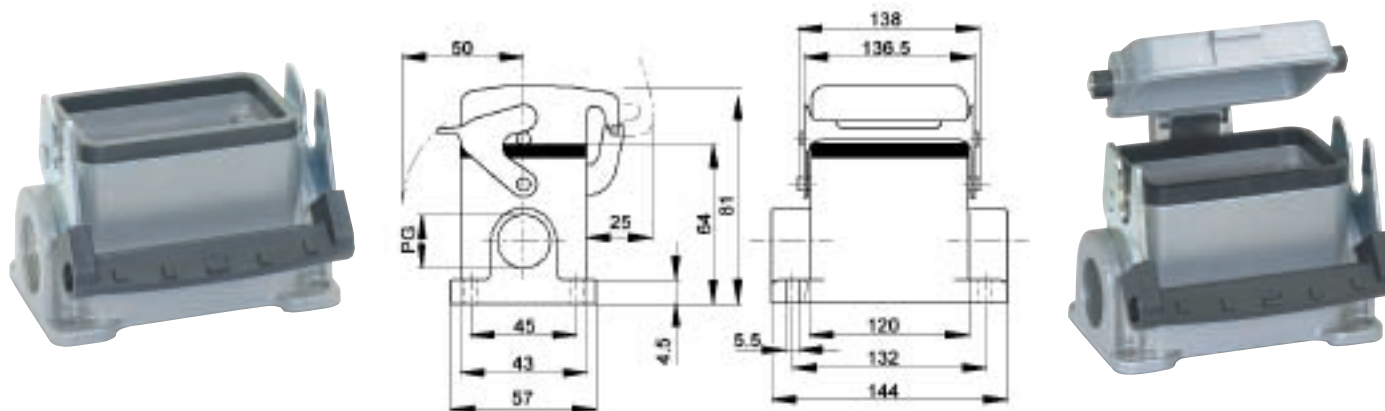

All dimensions are in mm.

# of Entries	Size of Entry			Standard Grey Coating			Black Coating (EP)		
	PG	NPT	Metric	PG Part #	NPT Part #	Metric Part #	PG Part #	NPT Part #	Metric Part #
2 Entries	21	3/4"	25	10.1059	10.1059 NP	19.1059	70.1630	70.1630 NP	79.1630
1 Entry	21	3/4"	25	10.1049	10.1049 NP	19.1049	70.1620	70.1620 NP	79.1620
2 with cover	21	3/4"	25	10.1099	10.1099 NP	19.1099	70.1670	70.1670 NP	79.1670
1 with cover	21	3/4"	25	10.1079	10.1079 NP	19.1079	70.1660	70.1660 NP	79.1660

DUST COVERS WITH ATTACHMENT STRING



Material: Thermoplastic Resin Temperature: -40°C to 125°C

	Part #
Dust cover with single lever for HBE 24 Hoods	10.1186
Dust cover with single lever bolts for HBE 24 Panel Mount or Surface MountBase/ Cable Coupler Hood	10.1187

EPIC® CONNECTORS

HBE 24 Housings: Single Lever on Base



SURFACE MOUNT BASES

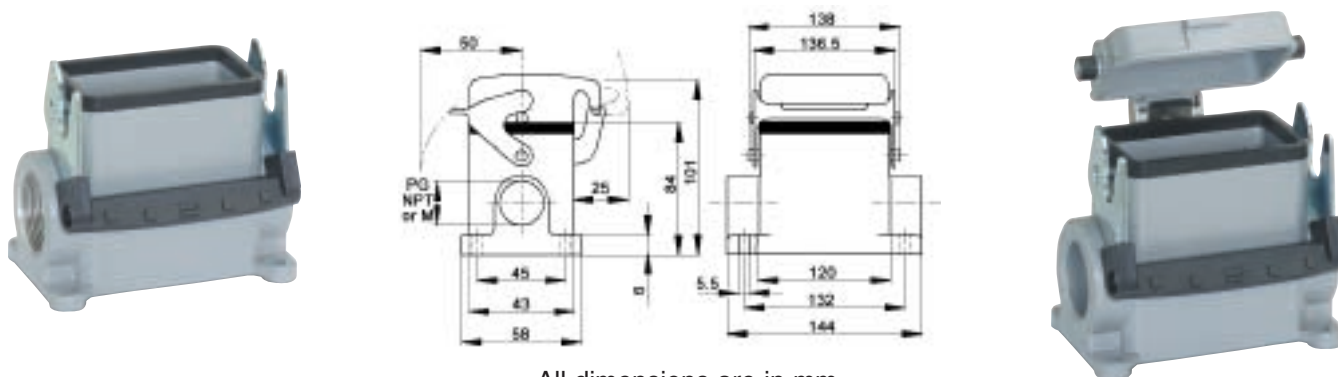

All dimensions are in mm.

# of Entries	Size of Entry			Standard Grey Coating			Black Coating (EP)		
	PG	NPT	Metric	PG Part #	NPT Part #	Metric Part #	PG Part #	NPT Part #	Metric Part #
2 Entries	21	3/4"	25	70.1612	70.1612 NP	79.1612	70.1632	70.1632 NP	79.1632
	29	1"	32	70.1614	70.1614 NP	79.1614	70.1634	70.1634 NP	79.1634
1 Entry	21	3/4"	25	70.1602	70.1602 NP	79.1602	70.1622	70.1622 NP	79.1622
	29	1"	32	70.1604	70.1604 NP	79.1604	70.1624	70.1624 NP	79.1624
2 Entries with dust cover	21	3/4"	25	70.1652	70.1652 NP	79.1652	70.1672	70.1672 NP	79.1672
	29	1"	32	70.1654	70.1654 NP	79.1654	70.1674	70.1674 NP	79.1674
1 Entry with dust cover	21	3/4"	25	70.1642	70.1642 NP	79.1642	70.1662	70.1662 NP	79.1662
	29	1"	32	70.1644	70.1644 NP	79.1644	70.1664	70.1664 NP	79.1664

CABLE COUPLER HOODS

STANDARD PROFILE

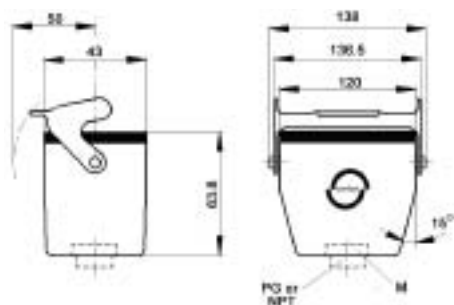

HIGH PROFILE

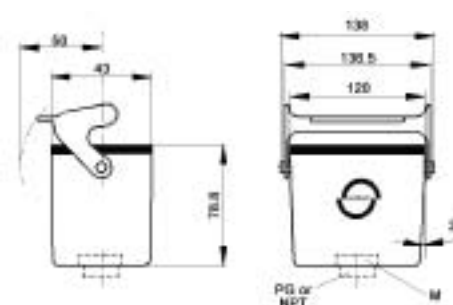

All dimensions are in mm.

Profile	Size of Entry			Standard Grey Coating			Black Coating (EP)		
	PG	NPT	Metric	PG Part #	NPT Part #	Metric Part #	PG Part #	NPT Part #	Metric Part #
Standard Profile	21	3/4"	25	10.1279	10.1279 NP	19.1279	70.1430	70.1430 NP	79.1430
	29	1"	32	10.1179	10.1179 NP	19.1179	70.1432	70.1432 NP	79.1432
High Profile	21	3/4"	25	70.1424	70.1424 NP	79.1424	70.1434	70.1434 NP	79.1434
	29	1"	32	70.1426	70.1426 NP	79.1426	70.1436	70.1436 NP	79.1436

Metric hoods do not come with a neck.

EPIC® CONNECTORS

HBE 24 Housings: Double Levers on Base



HOODS

TOP ENTRY

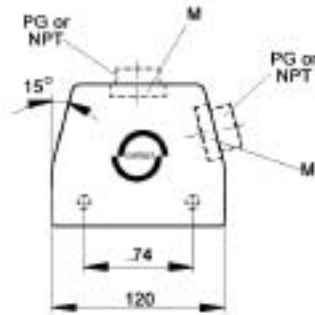
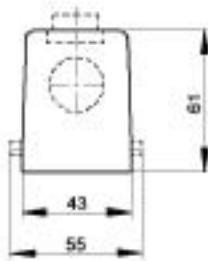

SIDE ENTRY



All dimensions are in mm.

Position of Cable Entry	Size of Entry			Standard Grey Coating			Black Coating (EP)		
	PG	NPT	Metric	PG Part #	NPT Part #	Metric Part #	PG Part #	NPT Part #	Metric Part #
Top Entry	21	3/4"	25	10.1210	10.1210 NP	19.1210	70.1510	70.1510 NP	79.1510
	29	1"	32	10.1110	10.1110 NP	19.1110	70.1512	70.1512 NP	79.1512
Side Entry	21	3/4"	25	10.1130	10.1130 NP	19.1130	70.1530	70.1530 NP	79.1530
	29	1"	32	10.1230	10.1230 NP	19.1230	70.1532	70.1532 NP	79.1532

Metric hoods do not come with a neck.

HIGH PROFILE HOODS

TOP ENTRY

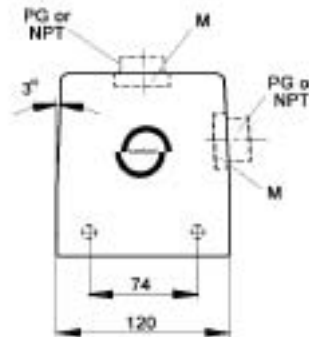
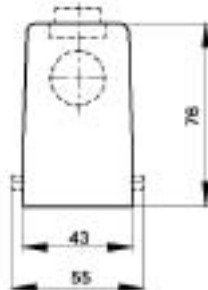

SIDE ENTRY



All dimensions are in mm.

Position of Cable Entry	Size of Entry			Standard Grey Coating			Black Coating (EP)		
	PG	NPT	Metric	PG Part #	NPT Part #	Metric Part #	PG Part #	NPT Part #	Metric Part #
Top Entry	21	3/4"	25	70.1504	70.1504 NP	79.1504	70.1514	70.1514 NP	79.1514
	29	1"	32	70.1506	70.1506 NP	79.1506	70.1516	70.1516 NP	79.1516
	-	-	40	-	-	79.1508	-	-	-
Side Entry	21	3/4"	25	70.1524	70.1524 NP	79.1524	70.1534	70.1534 NP	79.1534
	29	1"	32	70.1526	70.1526 NP	79.1526	70.1536	70.1536 NP	79.1536
	-	-	40	-	-	79.1528	-	-	-

Metric hoods do not come with a neck.

EPIC[®] CONNECTORS

HBE 24 Housings: Double Levers on Base



PANEL MOUNT BASES

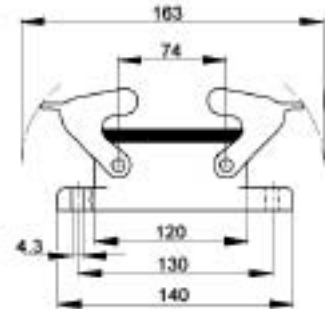
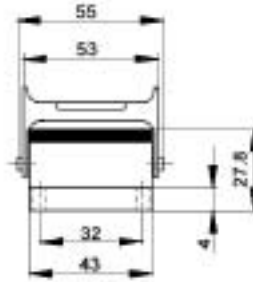
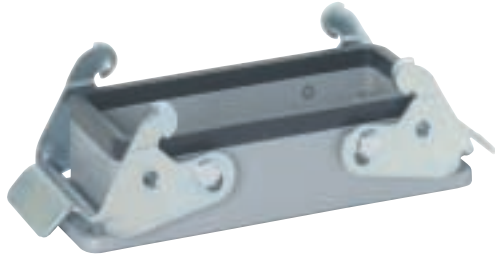

All dimensions are in mm.

Description	Standard Grey Coating	Black Coating (EP)
Panel Mount without Dust Cover	10.1020	70.1325

SURFACE MOUNT BASES

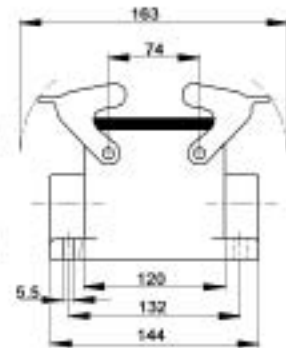
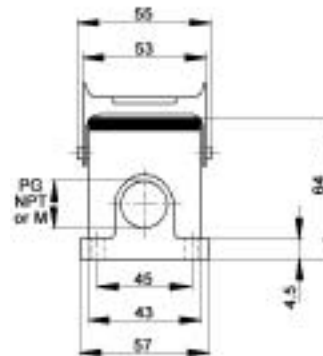
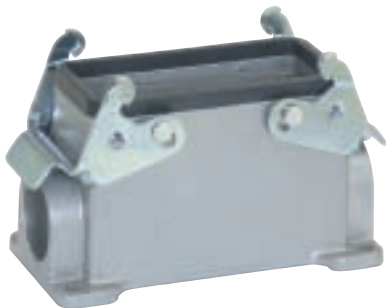

All dimensions are in mm.

# of Entries	Size of Entry			Standard Grey Coating			Black Coating (EP)		
	PG	NPT	Metric	PG Part #	NPT Part #	Metric Part #	PG Part #	NPT Part #	Metric Part #
2 Entries	21	3/4"	25	10.1050	10.1050 NP	19.1050	70.1380	70.1380 NP	79.1380
1 Entry	21	3/4"	25	10.1040	10.1040 NP	19.1040	70.1370	70.1370 NP	79.1370

DUST COVERS WITH ATTACHMENT STRING



Material: Thermoplastic Resin

Temperature: -40°C to 125°C

	Part #
Dust cover with double levers and gasket for HBE 24 Hoods	10.1195
Dust cover with double lever bolts for HBE 24 Panel Mount or Surface Mount Base/ Cable Coupler Hood	10.1180

EPIC® CONNECTORS

HBE 24 Housings: Double Levers on Base



HIGH PROFILE SURFACE MOUNT BASES

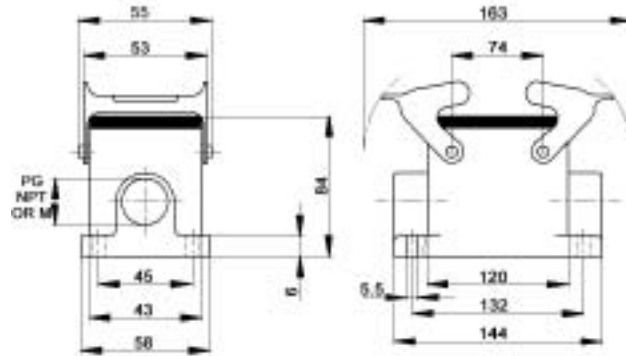

All dimensions are in mm.

# of Entries	Size of Entry			Standard Grey Coating			Black Coating (EP)		
	PG	NPT	Metric	PG Part #	NPT Part #	Metric Part #	PG Part #	NPT Part #	Metric Part #
2 Entries	21	3/4"	25	70.1362	70.1362 NP	79.1362	70.1382	70.1382 NP	79.1382
	29	1"	32	70.1364	70.1364 NP	79.1364	70.1384	70.1384 NP	79.1384
1 Entry	21	3/4"	25	70.1352	70.1352 NP	79.1352	70.1372	70.1372 NP	79.1372
	29	1"	32	70.1354	70.1354 NP	79.1354	70.1374	70.1374 NP	79.1374

CABLE COUPLER HOODS

STANDARD PROFILE

HIGH PROFILE

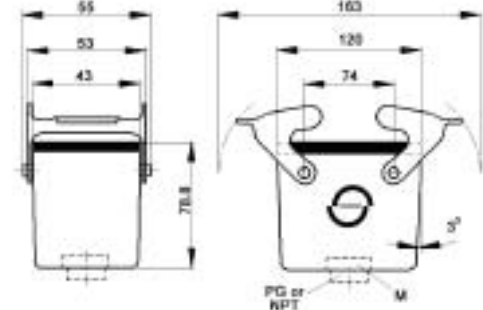
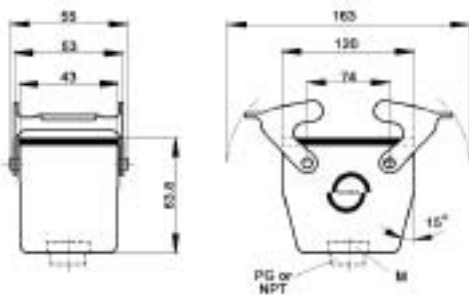

All dimensions are in mm.

Profile	Size of Entry			Standard Grey Coating			Black Coating (EP)		
	PG	NPT	Metric	PG Part #	NPT Part #	Metric Part #	PG Part #	NPT Part #	Metric Part #
Standard Profile	21	3/4"	25	10.1270	10.1270 NP	19.1270	70.1410	70.1410 NP	79.1410
	29	1"	32	10.1170	10.1170 NP	19.1170	70.1412	70.1412 NP	79.1412
High Profile	21	3/4"	25	70.1404	70.1404 NP	79.1404	70.1414	70.1414 NP	79.1414
	29	1"	32	70.1406	70.1406 NP	79.1406	70.1416	70.1416 NP	79.1416

Metric hoods do not come with a neck.

EPIC® CONNECTORS

HBE 24 Housings: Double Levers on Hood



HOODS

TOP ENTRY

SIDE ENTRY

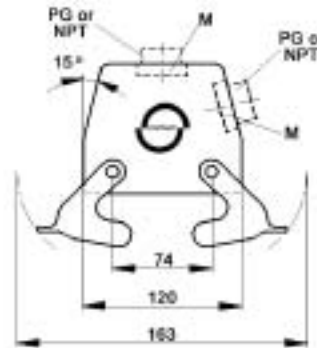
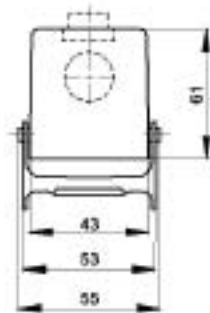

All dimensions are in mm.

Position of Cable Entry	Size of Entry			Standard Grey Coating			Black Coating (EP)		
	PG	NPT	Metric	PG Part #	NPT Part #	Metric Part #	PG Part #	NPT Part #	Metric Part #
Top Entry	21	3/4"	25	10.1220	10.1220 NP	19.1220	70.1560	70.1560 NP	79.1560
	29	1"	32	10.1120	10.1120 NP	19.1120	70.1562	70.1562 NP	79.1562
Side Entry	21	3/4"	25	10.1140	10.1140 NP	19.1140	70.1580	70.1580 NP	79.1580
	29	1"	32	10.1240	10.1240 NP	19.1240	70.1582	70.1582 NP	79.1582

Metric hoods do not come with a neck.

HIGH PROFILE HOODS

TOP ENTRY

SIDE ENTRY

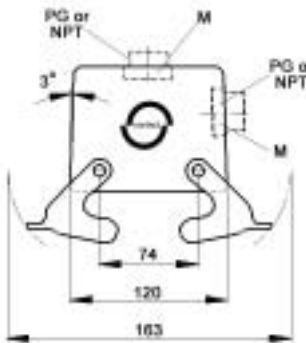
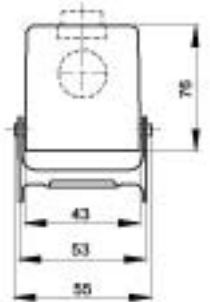

All dimensions are in mm.

Position of Cable Entry	Size of Entry			Standard Grey Coating			Black Coating (EP)		
	PG	NPT	Metric	PG Part #	NPT Part #	Metric Part #	PG Part #	NPT Part #	Metric Part #
Top Entry	21	3/4"	25	70.1554	70.1554 NP	79.1554	70.1564	70.1564 NP	79.1564
	29	1"	32	70.1556	70.1556 NP	79.1556	70.1566	70.1566 NP	79.1566
Side Entry	21	3/4"	25	70.1574	70.1574 NP	79.1574	70.1584	70.1584 NP	79.1584
	29	1"	32	70.1576	70.1576 NP	79.1576	70.1586	70.1586 NP	79.1586

Metric hoods do not come with a neck.

EPIC® CONNECTORS

HBE 24 Housings: Double Levers on Hood



PANEL MOUNT BASES

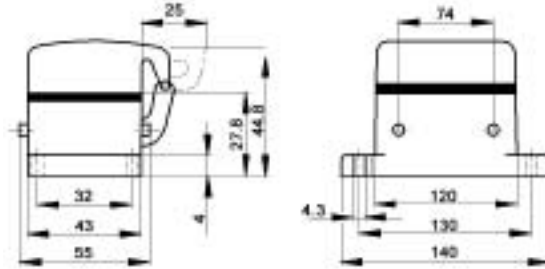

All dimensions are in mm.

Description	Standard Grey Coating	Black Coating (EP)
Panel Mount with Dust Cover	10.1030	70.1335
Panel Mount without Dust Cover	10.1031	-

SURFACE MOUNT BASES

STANDARD PROFILE

HIGH PROFILE

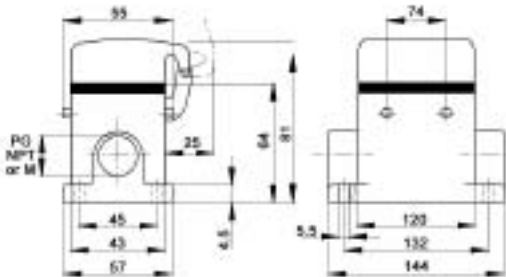

All dimensions are in mm.

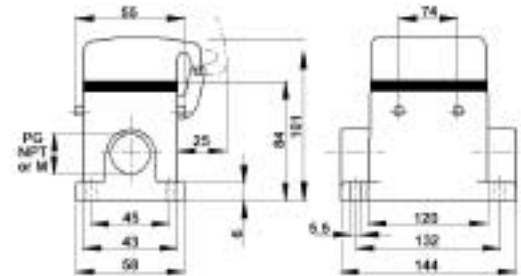

WITH DUST COVER

# of Entries	Size of Entry			Standard Grey Coating			Black Coating (EP)		
	PG	NPT	Metric	PG Part #	NPT Part #	Metric Part #	PG Part #	NPT Part #	Metric Part #
2 Entries	21	3/4"	25	10.1090	10.1090 NP	19.1090	70.1480	70.1480 NP	79.1480
1 Entry	21	3/4"	32	10.1070	10.1070 NP	19.1070	70.1470	70.1470 NP	79.1470
High Profile with 2 Entries	21	3/4"	25	70.1462	70.1462 NP	79.1462	70.1482	70.1482 NP	79.1482
High Profile with 1 Entry	29	1"	32	70.1464	70.1464 NP	79.1464	70.1484	70.1484 NP	79.1484
High Profile with 2 Entries	21	3/4"	25	70.1452	70.1452 NP	79.1452	70.1472	70.1472 NP	79.1472
High Profile with 1 Entry	29	1"	32	70.1454	70.1454 NP	79.1454	70.1474	70.1474 NP	79.1474

DUST COVERS WITH ATTACHMENT STRING



Material: Thermoplastic Resin Temperature: -40°C to 125°C

	Part #
Dust cover with double lever bolts and gasket for HBE 24 Hoods	10.1181

EPIC® CONNECTORS

HBE 32 Plugs & Receptacles



SCREW & CRIMP TERMINATED INSERTS

SCREW TERMINATED

View from Cable Side

CRIMP TERMINATED

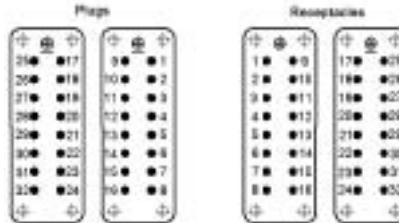
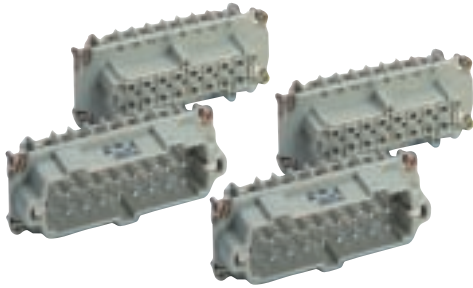

Panel Cut-Out
(Insert Only)

Contacts Sold Separately

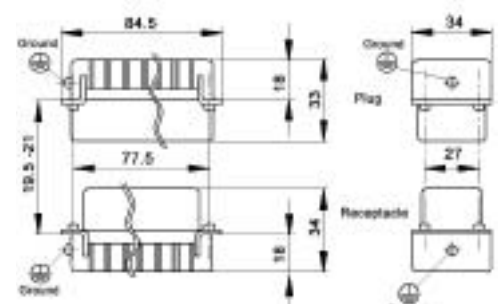
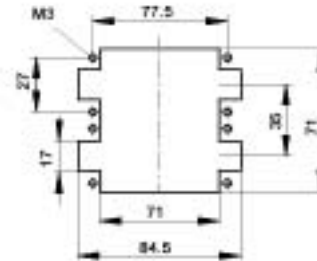
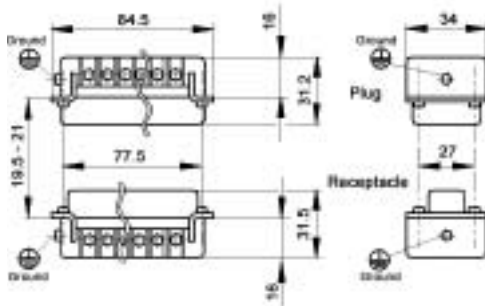

All dimensions are in mm.

These inserts
fit in the HBE
32 Series
Housings.

	Plug	Receptacle
Screw Terminated with wire protection (#1-16)	10.1940	10.1950
Screw Terminated with wire protection (#17-32)	10.2020	10.2030
Screw Terminated without wire protection (#1-16)	10.1941	10.1951
Screw Terminated without wire protection (#17-32)	10.2021	10.2031
Crimp Terminated: Machine (#1-16)	10.1840	10.1850
Crimp Terminated: Machine (#17-32)	10.1842	10.1852

Crimp
Contacts
are on the
next page.

SCREWLESS SPRING CAGE CLAMP INSERTS

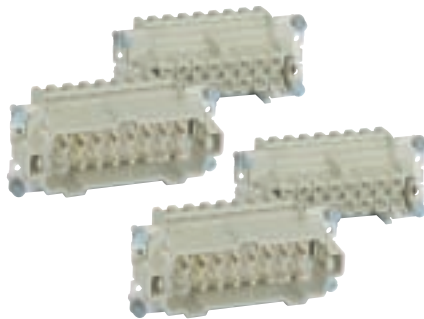

Panel Cut-Out

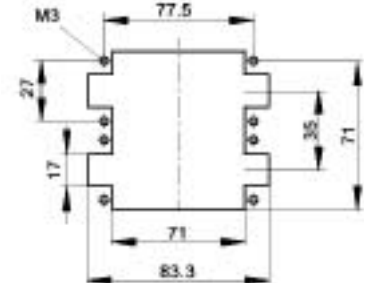
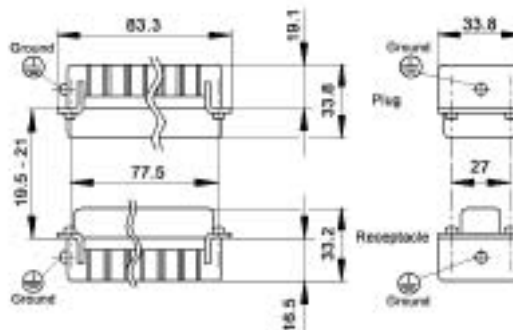

All dimensions are in mm.

Same View from
Cable Side as
Screw & Crimp
Termination

	Plug	Receptacle
Screwless Cage Clamp (#1-16)	10.4002	10.4012
Screwless Cage Clamp (#17-32)	10.4004	10.4014

These inserts
fit in the HBE
32 Series
Housings.

EPIC® CONNECTORS

Accessories for Crimp Terminated Inserts



HBE MACHINE CONTACTS: DIAMETER 2.5 MM

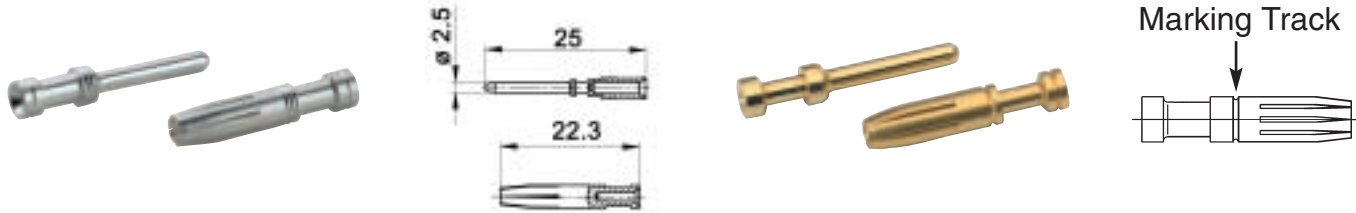

Bags of 100

mm ²	AWG	Silver		Gold		Stripping Length (mm)	# of Marking Tracks
		Pin	Socket	Pin	Socket		
0.5	20	11.1900	11.1950	11.1920	11.1970	Pin=7.4, Socket =7.3	-
.75 - 1.0	18	11.1901	11.1951	11.1921	11.1971	Pin=7.4, Socket =7.3	1
1.5	16	11.1902	11.1952	11.1922	11.1972	Pin=7.4, Socket =7.3	2
2.5	14	11.1903	11.1953	-	-	Pin=7.4, Socket =7.3	3
4.0	12	11.1904	11.1954	-	-	Pin=7.4, Socket =7.3	-

Part number= 1 contact

CRIMP TOOLS

Wire Gauge: 0.5 - 4.0 mm² for the HBE Crimp Inserts



Crimp Tool
11.1470



Locator
11.1472



Crimp Dies
11.1471

For removal of contacts use a slotted screwdriver. No special tool is necessary.

Please note that the crimp range for this tool is 0.14 to 2.5 mm² (AWG 26 - 14) with the appropriate crimp dies.

EPIC® CONNECTORS

HBE 32 Housings: Double Levers on Base



TOP ENTRY



HOODS

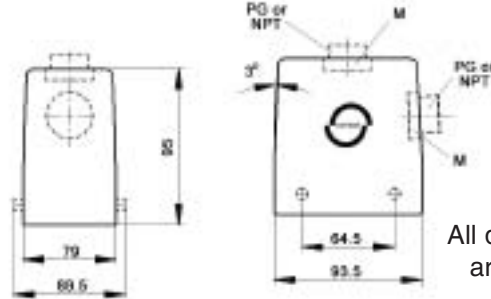

All dimensions are in mm.

SIDE ENTRY



Metric hoods do not come with a neck.

Position of Cable Entry	Size of Entry			Standard Grey Coating		
	PG	NPT	Metric	PG Part #	NPT Part #	Metric Part #
Top Entry	21	3/4"	-	10.1330	10.1330 NP	-
	29	1"	32	10.1340	10.1340 NP	19.1340
Side Entry	21	3/4"	25	10.1350	10.1350 NP	19.1350
	29	1"	32	10.1360	10.1360 NP	19.1360

Also Available
Top Entry:
Metric 40-
19.1344

Side Entry:
Metric 40-
19.1362

PANEL MOUNT BASES



Standard Grey Coating
10.1320

All dimensions are in mm.

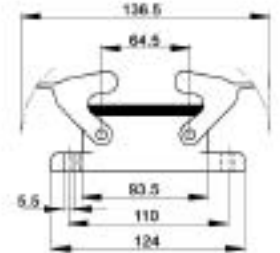

Dust cover with double lever bolts and attachment string: 10.1420

SURFACE MOUNT BASES

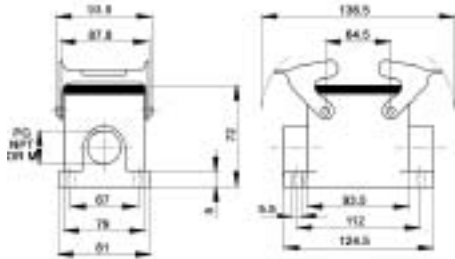

All dimensions are in mm.

# of Entries	Size of Entry			Standard Grey Coating		
	PG	NPT	Metric	PG Part #	NPT Part #	Metric Part #
2 Entries	29	1"	32	10.1380	10.1380 NP	19.1380
1 Entry	29	1"	32	10.1370	10.1370 NP	19.1370

Dust cover with double lever bolts and attachment string: 10.1420



CABLE COUPLER HOODS



Size of Entry		Standard Grey Coating			
PG	NPT	Metric	PG Part #	NPT Part #	Metric Part #
21	3/4"	-	10.1390	10.1390 NP	-
29	1"	32	10.1395	10.1395 NP	19.1395

Dust cover with double lever bolts and attachment string: 10.1420

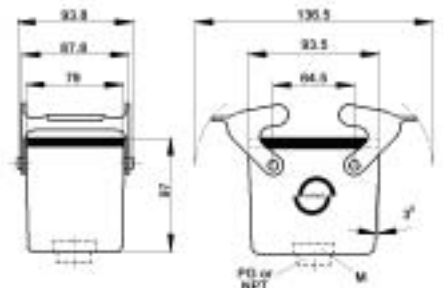

EPIC® CONNECTORS

HBE 32 Housings: Double Levers on Hood



HOODS

TOP ENTRY

SIDE ENTRY

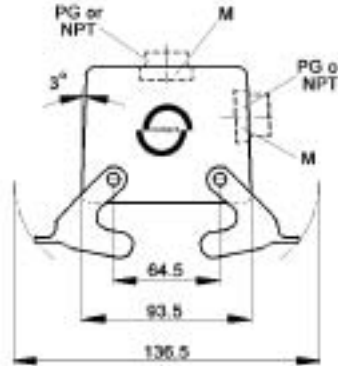
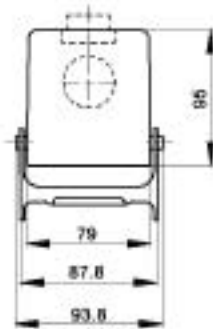

Position of Cable Entry	Size of Entry			Standard Grey Coating		
	PG	NPT	Metric	PG Part #	NPT Part #	Metric Part #
Top Entry	29	1"	32	70.2050	70.2050 NP	79.2050
Side Entry	29	1"	32	10.1366	10.1366 NP	19.1366

All dimensions are in mm.

Metric hoods do not come with a neck.

PANEL MOUNT BASES



Standard Grey Coating
10.1323

All dimensions are in mm.

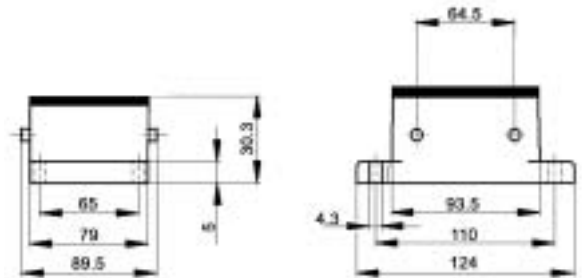

SURFACE MOUNT BASES

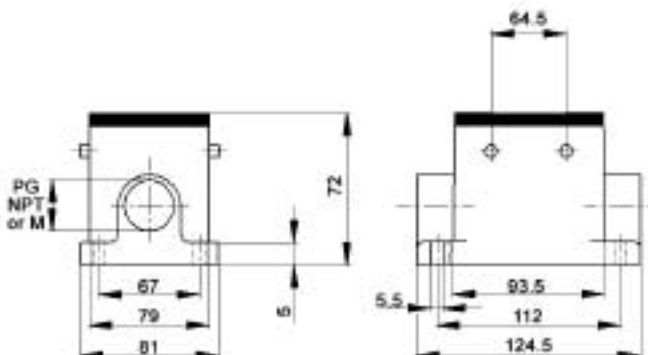

All dimensions are in mm.

# of Entries	Size of Entry			Standard Grey Coating		
	PG	NPT	Metric	PG Part #	NPT Part #	Metric Part #
1 Entry	29	1"	32	10.1373	10.1373 NP	-

EPIC® CONNECTORS

HBE 48 Plugs & Receptacles



SCREW & CRIMP TERMINATED INSERTS

SCREW TERMINATED

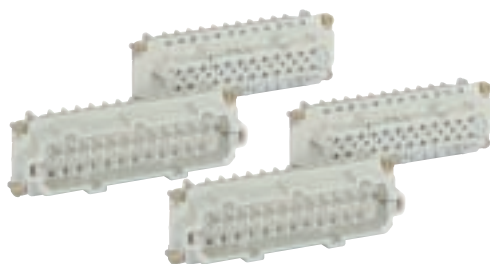

View from Cable Side

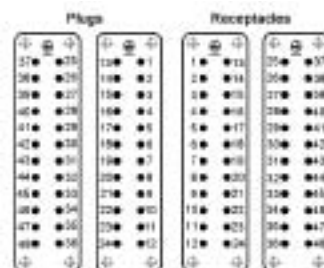

CRIMP TERMINATED

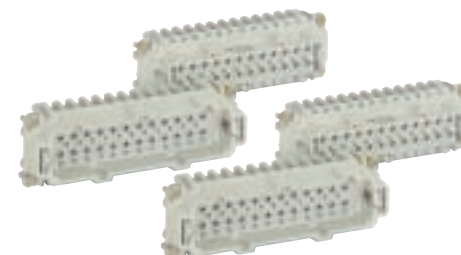

Panel Cut-Out

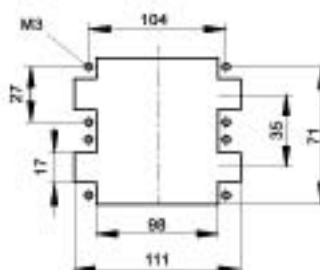

Contacts Sold Separately

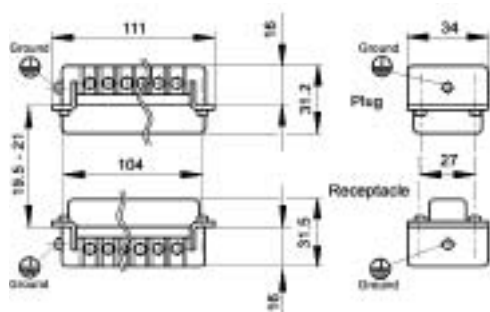
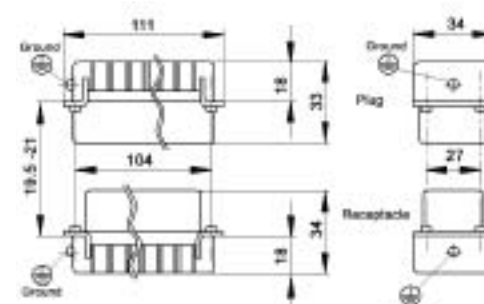

All dimensions are in mm.

These inserts fit in the HBE 48 Series Housings.

	Plug	Receptacle
Screw Terminated with wire protection (#1-24)	10.1960	10.1970
Screw Terminated with wire protection (#25-48)	10.2040	10.2050
Screw Terminated without wire protection (#1-24)	10.1961	10.1971
Screw Terminated without wire protection (#25-48)	10.2041	10.2051
Crimp Terminated: Machine (#1-24)	10.1860	10.1870
Crimp Terminated: Machine (#25-48)	10.1862	10.1872

Crimp Contacts are on the next page.

SCREWLESS SPRING CAGE CLAMP INSERTS

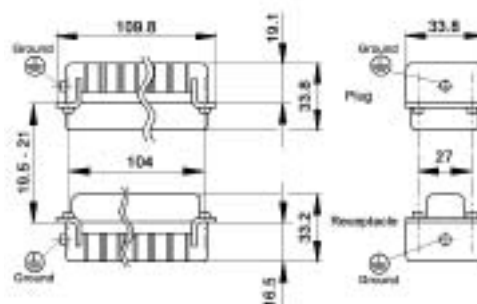
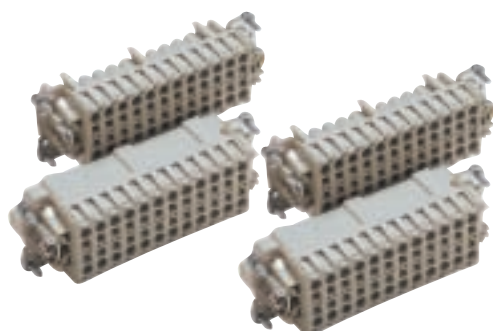

All dimensions are in mm.

Panel Cut-Out

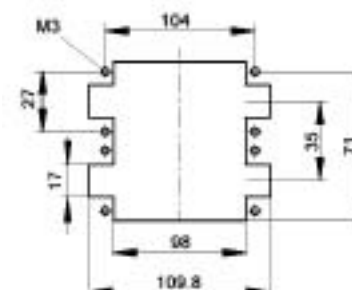

Same View from Cable Side as Screw & Crimp Termination

	Plug	Receptacle
Screwless Cage Clamp (#1-24)	10.4003	10.4013
Screwless Cage Clamp (#25-48)	10.4005	10.4015

These inserts fit in the HBE 48 Series Housings.

EPIC® CONNECTORS

Accessories for Crimp Terminated Inserts



HBE MACHINE CONTACTS: DIAMETER 2.5 MM

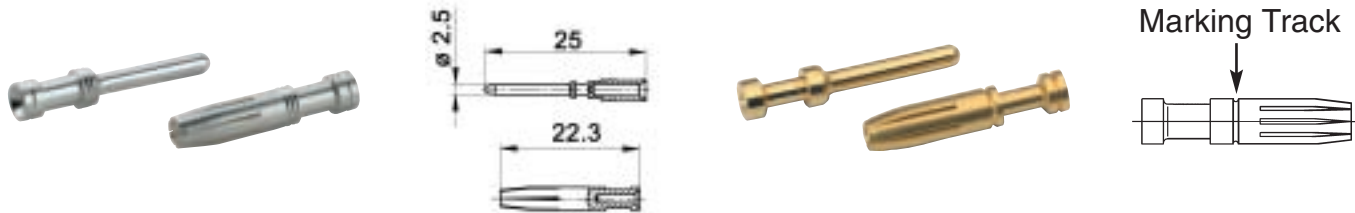

Bags of 100

mm ²	AWG	Silver		Gold		Stripping Length (mm)	# of Marking Tracks
		Pin	Socket	Pin	Socket		
0.5	20	11.1900	11.1950	11.1920	11.1970	Pin=7.4, Socket =7.3	-
.75 - 1.0	18	11.1901	11.1951	11.1921	11.1971	Pin=7.4, Socket =7.3	1
1.5	16	11.1902	11.1952	11.1922	11.1972	Pin=7.4, Socket =7.3	2
2.5	14	11.1903	11.1953	-	-	Pin=7.4, Socket =7.3	3
4.0	12	11.1904	11.1954	-	-	Pin=7.4, Socket =7.3	-

Part number= 1 contact

CRIMP TOOLS

Wire Gauge: 0.5 - 4.0 mm² for the HBE Crimp Inserts



Crimp Tool
11.1470



Locator
11.1472



Crimp Dies
11.1471

For removal of contacts use a slotted screwdriver. No special tool is necessary.

Please note that the crimp range for this tool is 0.14 to 2.5 mm² (AWG 26 - 14) with the appropriate crimp dies.

EPIC® CONNECTORS

HBE 48 Housings: Single Lever on Base



HOODS

TOP ENTRY

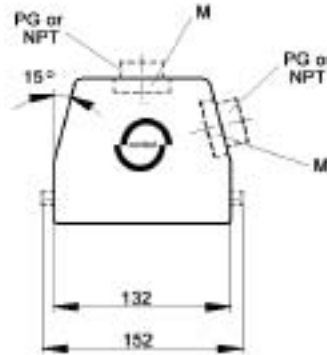

SIDE ENTRY

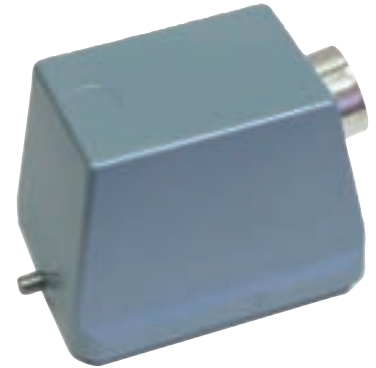

Position of Cable Entry	Size of Entry			Standard Grey Coating		
	PG	NPT	Metric	PG Part #	NPT Part #	Metric Part #
Top Entry	29	1"	32	10.1550	10.1550 NP	19.1550
	36	1 1/4"	40	10.1560	10.1560 NP	19.1560
	42	-	50	10.1570	-	19.1570
Side Entry	29	1"	32	10.1580	10.1580 NP	19.1580
	36	1 1/4"	40	10.1590	10.1590 NP	19.1590
	42	-	50	10.1600	-	19.1600

All dimensions are in mm.

Metric hoods do not come with a neck.

PANEL MOUNT BASES

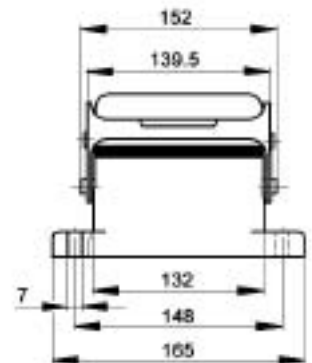
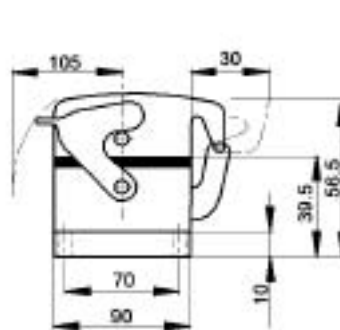

All dimensions are in mm.

Without Dust Cover	With Dust Cover with hold down screw and no dust cover bolts	With Dust Cover with hold down screw and dust cover bolts
10.1610	10.1520	10.1525

EPIC® CONNECTORS

HBE 48 Housings: Single Lever on Base



SURFACE MOUNT BASES

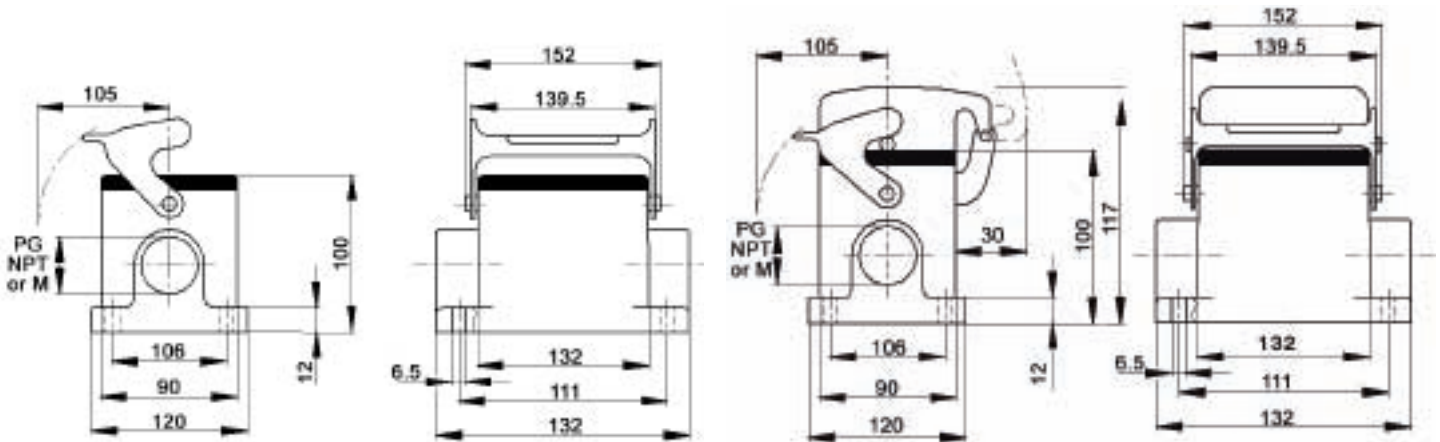

All dimensions are in mm.

# of Entries	Size of Entry			Standard Grey Coating		
	PG	NPT	Metric	PG Part #	NPT Part #	Metric Part #
2 Entries	29	1"	32	10.1660	10.1660 NP	19.1660
	36	1 1/4"	40	10.1661	10.1661 NP	19.1661
1 Entry	29	1"	32	10.1650	10.1650 NP	19.1650
	36	1 1/4"	40	10.1651	10.1651 NP	19.1651
2 Entries with dust cover	29	1"	32	10.1680	10.1680 NP	19.1680
	36	1 1/4"	40	10.1681	10.1681 NP	19.1681
1 Entry with dust cover	29	1"	32	10.1670	10.1670 NP	19.1670
	36	1 1/4"	40	10.1671	10.1671 NP	19.1671